



AKIKO

FOR CHARTER

SPECIFICATIONS

Builder	/ ALLOY YACHTS
Year	/ 2007 (refit 2023)
Length	/ 34.20 m / 112'2"
Beam	/ 7.72 m / 25'4"
Draft	/ 2.40 m / 7'1"
Max Speed	/ 13 knots
Cruising Speed	/ 10 knots
Guests	/ 12 in 5 cabins



ABOUT AKIKO

Meet M/Y AKIKO, an extraordinary 34-meter explorer yacht designed to navigate the world's most picturesque coral atolls. Renowned for her versatility, this award-winning vessel boasts expansive living areas adorned with full-height windows that offer breathtaking views of the surrounding beauty.

Crafted with meticulous attention to detail, her interior is a testament to luxury, providing vibrant and individual spaces for up to 10 guests. With sleek, robust exterior lines, M/Y AKIKO is not just a vessel but a statement of exploration.

Built by Alloy Yachts in 2007, she garnered five prestigious accolades at the 2008 World Superyacht Awards, a testament to her exceptional design and craftsmanship. Beyond luxury, AKIKO offers an unparalleled fishing experience, featuring a spacious cockpit equipped with fridge/freezers and live bait tanks. With a generous beam of 7.8 meters, she provides expansive space rarely found in a 35-meter superyacht, making her the epitome of elegance and adventure on the high seas.





ākikō



EXTERIOR

AKIKO's exterior is a harmonious blend of functionality and sophistication, designed to enhance every moment of exploration. Atop the sun deck, a sprawling L-shaped sofa beckons guests to unwind in comfort, complemented by inviting armchairs for intimate conversations under the sun or stars.

The bridge deck seamlessly integrates tender storage, ensuring easy access to waterborne adventures while maximizing deck space for leisure. The foredeck offers another place for relaxation with a comfortable seating area.

Main deck provides large undercover entertaining area with barbecue and oversize swim platform for accessing the tender and watertoys. A long sofa gracefully lines the dining table, offering a picturesque setting for alfresco meals against the backdrop of breathtaking seascapes.

With meticulous attention to detail and thoughtful design, AKIKO's exterior invites guests to immerse themselves in the beauty of the journey, creating unforgettable memories at every turn.



EXTERIOR / SUN DECK

AKIKO



EXTERIOR / SUN DECK

AKIKO



EXTERIOR / BOW

AKIKO



EXTERIOR // BOW

AKIKO



EXTERIOR / MAIN DECK

AKIKO



EXTERIOR / MAIN DECK

AKIKO

INTERIOR

The impeccable interiors aboard AKIKO are the vision of Gregory Marshall, with recent refit work undertaken at McMullen and Wing. The décor is a sublime fusion of timbers, textures and ochre hues, along with large windows to capture the passing landscapes at every angle and LED lighting to set of her remarkable collection of art and sculptures collected from around the world.

AKIKO is a true floating art gallery, with collections from Melanesia, Australian Aboriginal artworks, and rich, vibrant fabrics and furnishings reflecting her New Zealand origins and South Pacific travels.

For her guests' enjoyment, AKIKO is equipped with Apple TV, Chromecast, Crestron system and iTunes movie bank (with hard drive capacity for approximately 500 movies) and Foxtel (Satellite Television). AKIKO is fitted with stabilizers for comfort in all conditions, is air-conditioned throughout and provides very fast internet via Starlink.





INTERIOR / DINING ROOM

AKIKO



INTERIOR / DINING ROOM

AKIKO



INTERIOR / DINING ROOM

AKIKO



INTERIOR / SALON

AKIKO



INTERIOR / GALLEY

AKIKO



THE CABINS

M/Y AKIKO offers unparalleled comfort and accommodation for up to 12 guests across five luxurious cabins, ensuring every guest enjoys a lavish retreat at sea. The bridge deck features a magnificent full beam Master cabin, boasting expansive space and a large en-suite bathroom for ultimate relaxation and privacy.

On the main deck, a full beam VIP cabin awaits, providing a serene sanctuary with its own en-suite bathroom.

Below deck, a full beam double cabin sits alongside two twin cabins, each equipped with an additional pullman bed, and all featuring en-suite bathrooms, offering flexibility and comfort for guests of all ages. With sumptuous furnishings and thoughtful amenities, AKIKO's cabins redefine luxury living on the water, promising a restful and rejuvenating experience for all aboard.



INTERIOR / MASTER CABIN

AKIKO



INTERIOR / MASTER CABIN

AKIKO



INTERIOR / MASTER CABIN



AKIKO



INTERIOR / VIP CABIN

AKIKO



INTERIOR / VIP CABIN

AKIKO



INTERIOR / VIP CABIN

AKIKO



INTERIOR / GUEST CABIN

AKIKO



INTERIOR / GUEST CABIN

AKIKO



INTERIOR / GUEST CABIN

AKIKO

LAYOUT

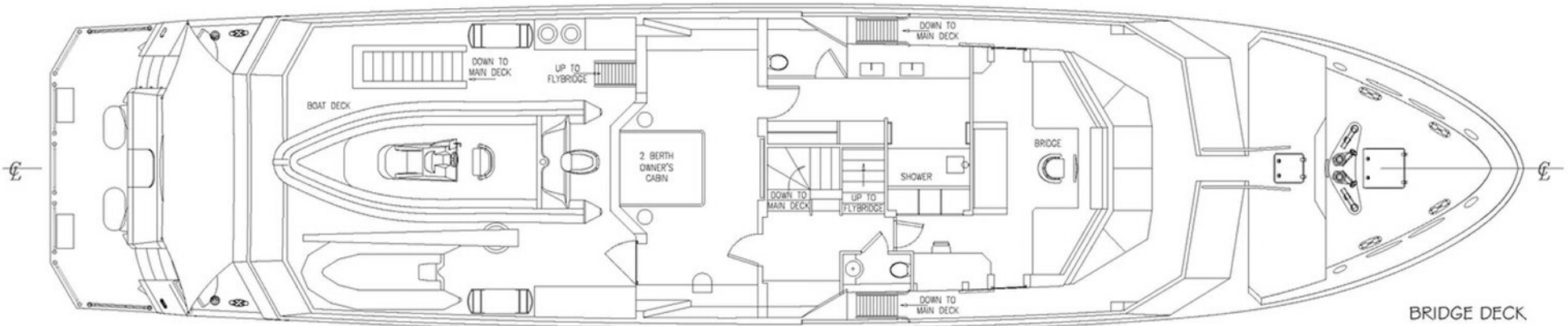
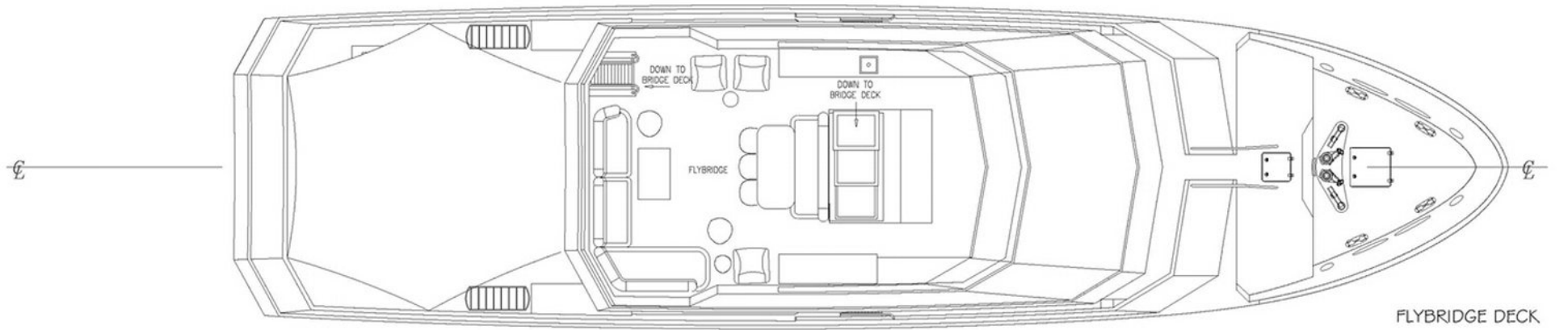

LAYOUT

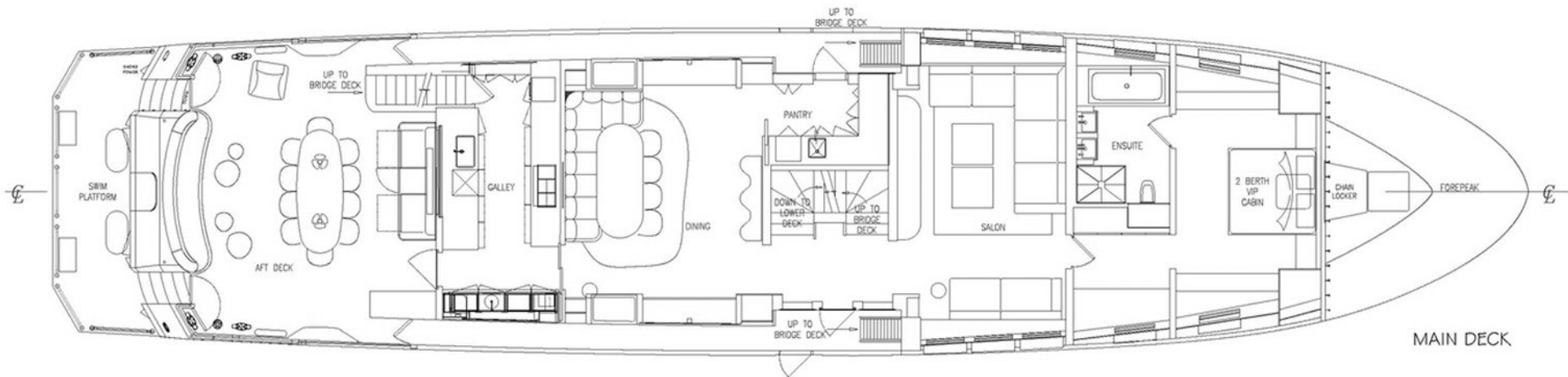

34 33 32 31 30 29 28 27 26 25 24 23 22 21 20 19 18 17 16 15 14 13 12 11 10 9 8 7 6 5 4 3 2 1

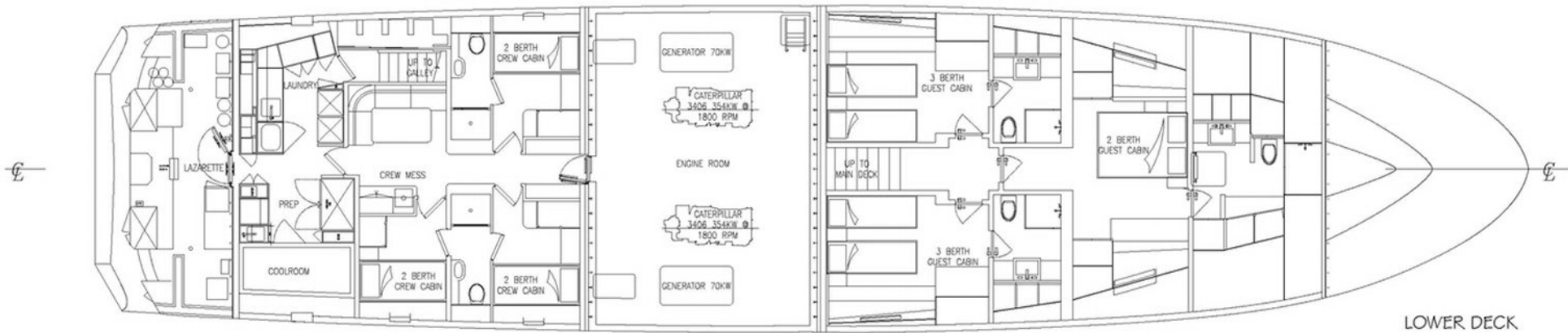

SPECIFICATIONS

GENERAL

BUILDER	/	ALLOY YACHTS
YEAR	/	2007
REFIT	/	2023
NAVAL ARCHITECT	/	Gregory C. Marshall Naval Architect
EXTERIOR DESIGN	/	Gregory C. Marshall Naval Architect
INTERIOR DESIGN	/	Lahaus
FLAG	/	Cook Islands
CLASSIFICATION	/	Lloyd's Register (Lloyd's +100 A1 SSC Yacht Mono G6, LMC, MCA)

DIMENSIONS

LENGTH OVERALL	/	34.20 m / 112'2"
LENGTH AT WATERLINE	/	30.14 m / 98'1"
BEAM	/	7.72 m / 25'4"
DRAFT	/	2.40 m / 7'1"

PERFORMANCE

MAX SPEED	/	13 knots
CRUISING SPEED	/	10 knots

RANGE	/	3,500nm at 8 knots
FUEL CONSUMPTION	/	90 L/hr at 10 knots
	/	60 L/hr at 8 knots

ACCOMMODATIONS

GUEST CABINS	/	1 x Master cabin
	/	1 x VIP cabin
	/	1 x Double cabin
	/	2 x Twin cabins (with extra pullman beds)
GUESTS CAPACITY	/	12 guests in 5 cabins

SPECIFICATIONS

TENDERS & TOYS

TENDERS

- / 1 x 7.50m Smuggler Marine Ltd RIB Tender (2018) - up to 10 guests
- / 1 x Aquapro 15 Hp Mercury

TOYS

- / x4 hard shell paddle boards
- / x1 SeaBob
- / x4 SCUBA sets
- / x1 Inflatable Kayak (looking to purchase a second)
- / x1 Inflatable towable water tube "Typhoon"
- / 1x water skies
- / 1x wake board
- / 1x Inflatable jelly fish pool (BoomSwim 4x5m)
- / x6 Fishing rods & gear of mixed sizes

KEY FEATURES

- / Extensive 2023 refit with full repaint, redesign of the aft deck and interior refurbishment
- / Built to explore remote regions, perfect for off-the-beaten-track adventures
- / Full beam owner's cabin with aft deck
- / Excellent volume throughout with 281GT
- / Private and covered deck spaces for complete relaxation
- / Zero speed stabilisers

LOCATION

Winter 2025, East Coast AUSTRALIA

Great Barrier Reef
WhitSundays

Flat Rate

AUD\$155,000 per week

Summer 2025, East Coast AUSTRALIA & PACIFIC

Great Barrier Reef
Solomon Islands, Vanuatu, New Caledonia,
Fiji, Papua New Guinea,

Flat Rate

AUD\$155,000 per week

Price excludes VAT + 35% APA



CREW / TEAM PHOTO

AKIKO



AKIKO

