



By Proteksan Turquoise Yachts Inc.

BARAKA



*'Baraka', at 58.20m (191 ft.), is an exceptionally spacious yacht based on a tried and tested hull platform. Naval architecture for this stylish yacht was produced in-house by the highly experienced Proteksan Turquoise engineering team. The stunning modern interior was designed by Francesco Paszkowski at the Florence based Paszkowski Design Studio, renowned for its many previous luxury yacht projects. With a cruising speed of 15 knots (maximum 17 knots) 'Baraka' is a true world cruising yacht with a range of 4,000 NM at 14 knots. Baraka is built to ABS, *A1 E, *AMS A1, MCA LY2 Compliance.*



Owners now expect to fully enjoy the experience of a close relationship with the marine environment, interior spaces connect to the exterior with large windows and the deck spaces offer both vistas from the upper sun deck to the shelter of informal or formal dining on aft deck areas. 'Baraka' does these things in abundance and style. The upper deck runs through the mast section giving an aft seating area, covered wet bar, BBQ and a sauna. Forward is the jacuzzi placed centrally for the best panoramic views, surrounded by a sea of sunbathing cushions.

The bridge deck has a large semi-covered dining area with wide glazed doors to the upper salon. A novel feature is the small seating area in front of the bridge. The aft main deck offers another opportunity for dining or just relaxing watching the water-borne antics on the many on-board 'toys'. A key feature of 'Baraka' is the exceptionally large and spacious garage where clam-doors house two Nautical Structure cranes deploying two large tenders, one at 22 ft, the smaller being 15 ft.

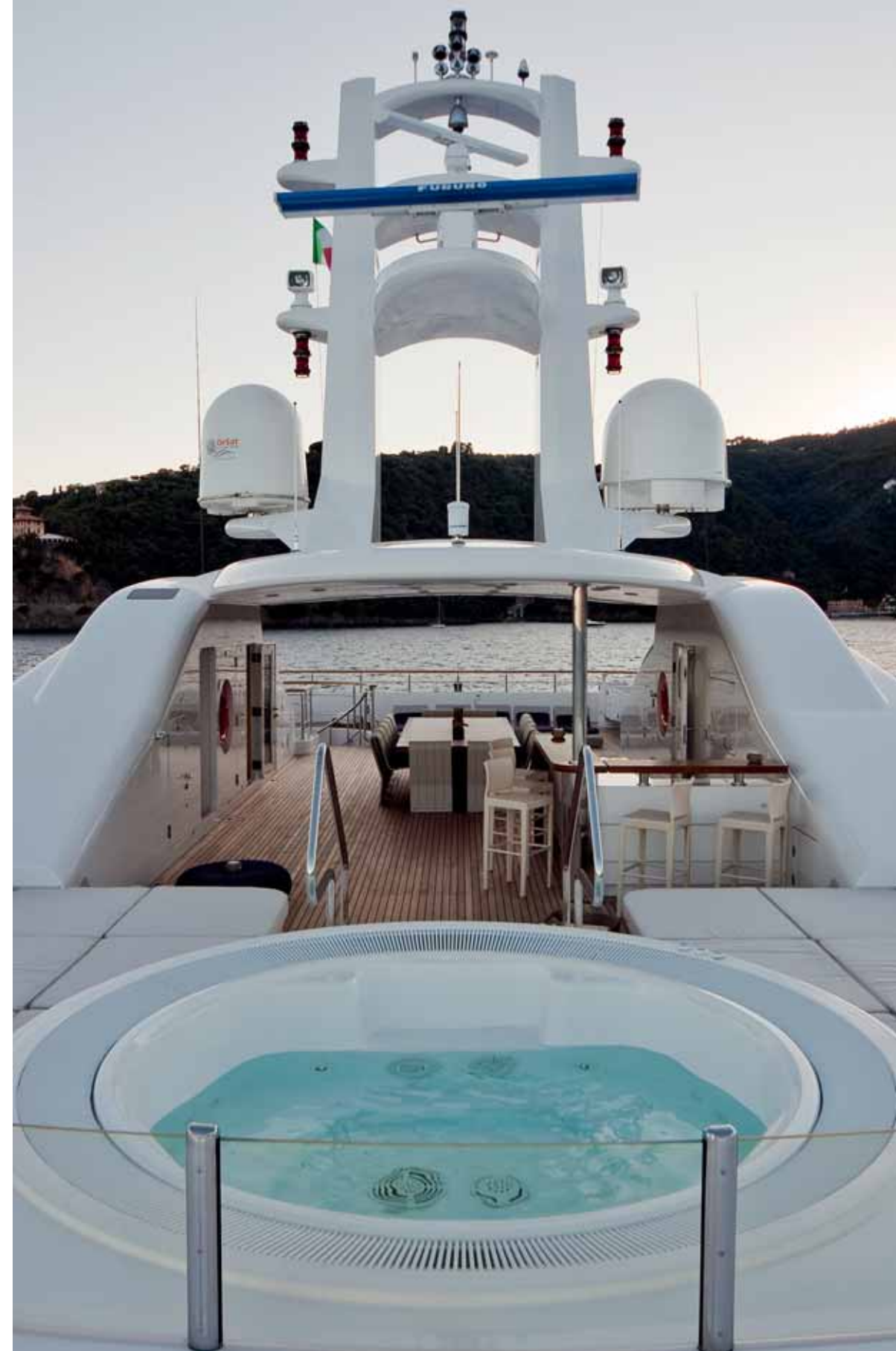



The interior of 'Baraka' is a fresh approach; large open spaces, the clean lines and angular geometry accentuated by plain surfaces punctuated by texture and splashes of colour. The modern spacious galley and pantry arrangement supports the guests in the adjacent dining room, which is open plan with a sight-line directly to the main salon. A feature is the food lift to all three decks and a second 'utility' lift, again to all three decks, including the crew areas. Walking into the main salon the first impression is how the colours of the sea and surroundings reflect in the white deck-head and wall panels. Splashes of red and the richly patterned red carpet send the eye back from the views outside to the comfort of the interior.



One of the many features found in the overall layout is the large internal volume allowing a big canvas for creating a memorable design scheme. The upper deck comprises of the large half covered aft dining area which can be opened up through large glazed doors into the stylish upper sky-lounge which has two seating areas and a large plasma screen for essential viewing.



The white signature décor creates a light airy atmosphere complemented by the large windows. Quiet moments can be had in the upper deck library but the fully equipped gym beckons for the health-conscious. Stepping out to the aft deck you may notice the cooling effect of the 'fog' cooling system mounted in the deck head.





A central feature of 'Baraka' is the massive full beam master bedroom with large picture windows on either side, reached from a special lobby area. The dark floor covering creates the foundation for the eye to travel around this large space, while the white walls and deck head create the airy headroom. Adjacent is the master office area and master bathroom.





The striking feature here is the free standing oval bath and the tiled wall covering that brings colour and texture to the luxurious surroundings.



The four 'queen' guest bedrooms have a similar layout and the signature white design for each. Individuality is created by different colour-ways in each cabin.

*The total accommodation of 12 guests aboard 'Baraka' comprises of the master suite, four 'queen' guest suites and a VIP suite on the main deck.
The 12 crew members enjoy no less than six crew cabins supported by a large mess area.*



The upperdeck may be the ideal place to enjoy the al fresco lifestyle while enjoying the sunshine and jacuzzi but what a perfect vantage point to enjoy the evening atmosphere and take in your surroundings, whether a moonlit bay or a busy port. Small tables and the bar area, sheltered by the mast section, allow small groups to enjoy intimate conversations, but it is still a location where you can clear the decks for a party under the stars.

While the upper lounge offers the ideal place to enjoy your favourite movie or watch that important match, a step away through the large aft doors takes you onto the vast aft deck with panoramic views and abundant seating. The partially covered overhead allows perfect open air dining at the impressive table and seating arrangement. Conveniently placed stairs access the main deck and the upperdeck.



The lower aft deck of 'Baraka' is given over to functional requirements. The stern platform drops to reveal the beach club and further forward the huge port garage houses the 22ft Nautica RIB in a fore and aft fashion while the sister 15 ft RIB is launched from the smaller clam door to starboard.

In keeping with the uncluttered interior design, the bridge area is a masterpiece in functionality and layout. The bridge is equipped with the latest navigation technology and offers excellent visibility.





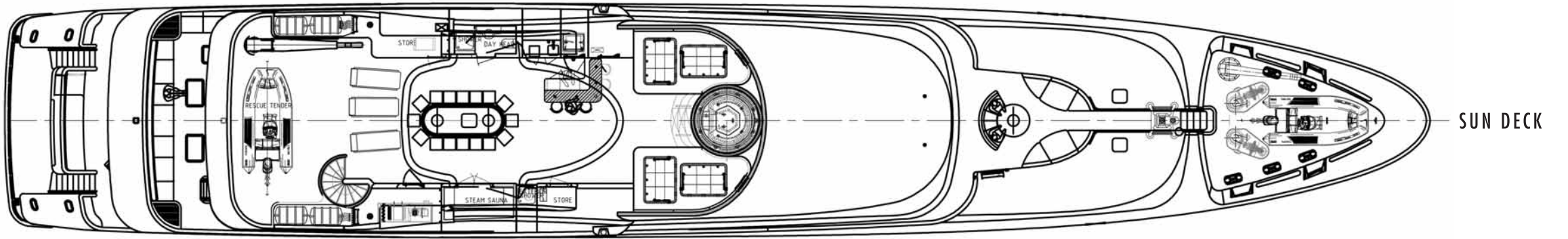

SUN DECK

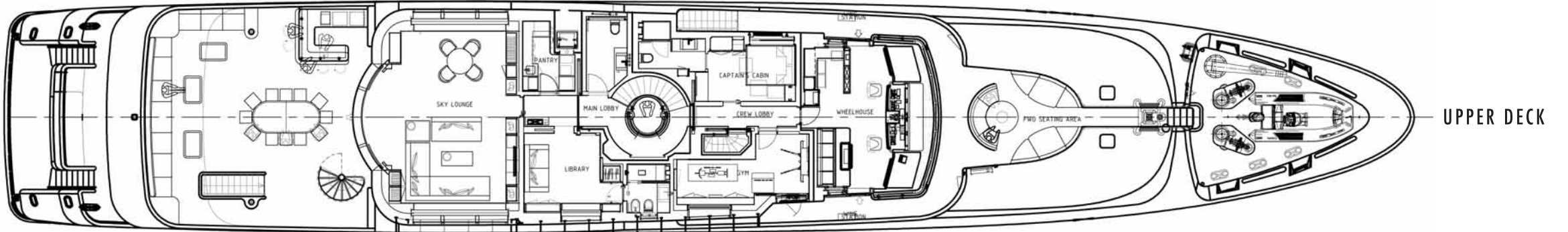

UPPER DECK

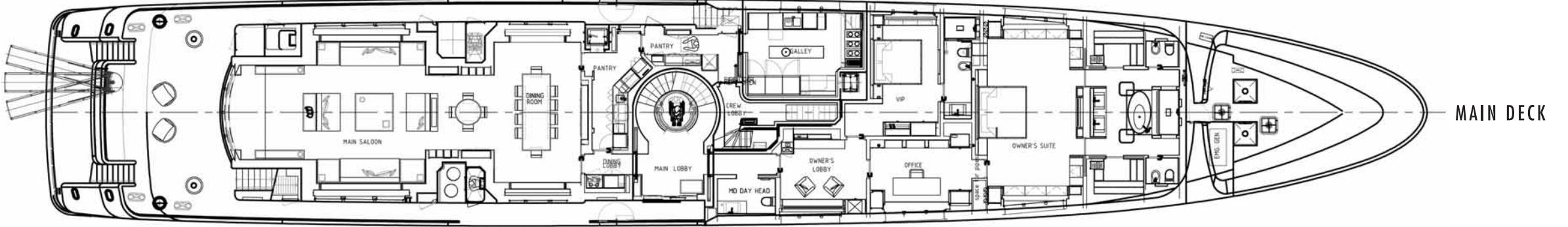

MAIN DECK

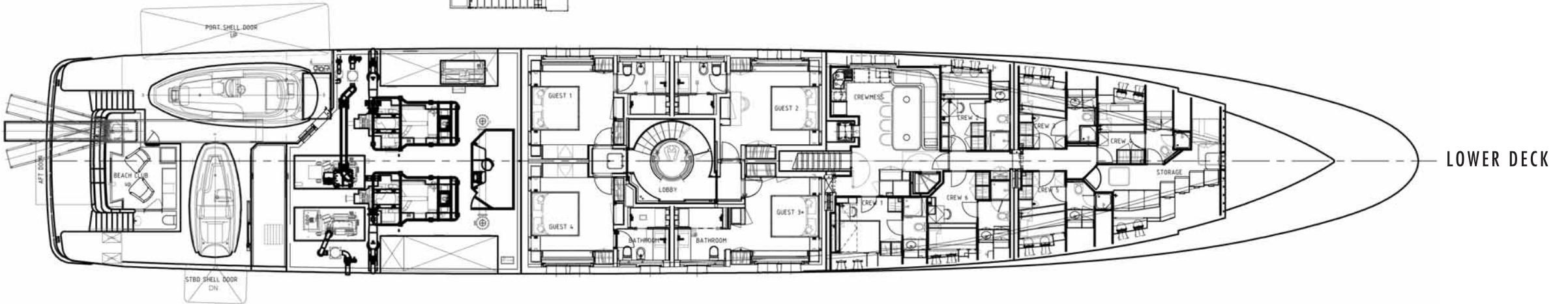

LOWER DECK

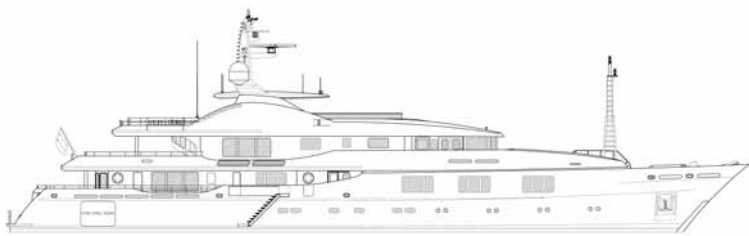

PROFILE

TYPE

Twin screw motor yacht

MAIN PARTICULARS:

- Length O.A : 58.20 meters
- Length W.L : 52.30 meters
- Beam : 9.60 meters
- Draft : 3.30 meters
- Displacement : 870 tons
- Speed (max) : 17 knots
- Speed (cruise) : 15 knots
- Range : 5,000 nm

YEAR BUILT:

- 2010

BUILDER:

- Proteksan Turquoise Yachts Inc.

DESIGNER & NAVAL ARCHITECT:

- Proteksan-Turquoise Yachts Inc.

EXTERIOR STYLIST:

- H2 Yacht Design

INTERIOR STYLIST:

- Francesco Paszkowski Design

INTERIOR MANUFACTURER:

- ULUTAS

BUILDER'S PROJECT MANAGER:

- Alper Kağan Küçük

OWNER'S PROJECT MANAGER:

- Searoni Ltd.

CONSTRUCTION:

- Steel Hull and Aluminum alloy Superstructure

CLASSIFICATION:

- ABS, ⚡ A1, E, ⚡ AMS, Yachting service, MCA LY2

ACCOMMODATION

OWNER & GUESTS: 12

- 1 x master stateroom
- 1 x VIP cabin
- 4 x Guest cabin

CREW

: 12

MACHINERY

- Main engines : CATERPILLAR 2x1911 BHP 3512B
B-rating @1600 RPM
- Gearbox : MGZ 5600, I=2,98:1
- Flexible coupling : CENTA
- Propellers : SCHAFFRAN
- Shafts : SCHAFFRAN
- Engine mounts : LO-REZ
- Flanged coupling : LO-REZ
- Steering gear : DATA HIDROLIK
- Engine controls : TWINDISC EC 300
- Generators (main) : 2 X 175kW CATERPILLAR C9
- Generator (Harbor) : 1x 86 kW CATERPILLAR C 4.4
- Generator (Emerg.) : 1x 86 kW CATERPILLAR C 4.4
- Main & distribution panels : HAKAN ELEKTRIK

TANK CAPACITIES

- Fuel : 140'000 liters
- Water : 24'000 liters
- Gray & Black W. : 36'000 liters

ANCILLARY EQUIPMENT

- Bow thruster : JASTRAM
- Anchor & chains : WORTELBOER
- Stabilizer : QUANTUM Zero Speed
- Air conditioning system : HEINEN HOPMAN
- Sewage treatment system : HAMANN
- Vacuum toilet system : JETS
- Watermakers : IDROMAR
- Fresh water pumps : WILO
- Heaters : GIANNESCHI
- Oily bilge separator : RWO

SAFETY & SECURITY EQUIPMENT

- Fire detection system : CONCILIUM
- Fire extinguishing system : MARIOFF
- Monitoring system : SCHNEIDER/HAKAN ELEKTRIK
- Security system : PANASONIC

NAVIGATION ELECTRONICS

- Navigational equipment : OZSAY / FURUNO

COMMUNICATION EQUIPMENT

- GMDSS : FURUNO, SAILOR
- INTERCOM : FURUNO

DECK EQUIPMENT

- Tender-launching system : NAUTICAL STRUCTURES
- SOLAS crane : SANGUINETI
- Windlasses & capstans : DATA HIDROLIK

AUDIO/VISUAL ENTERTAINMENT SYSTEMS

- Entertainment system : HED CINEMA
- SAT TV systems : ORBIT

DOMESTIC EQUIPMENT

- Galley equipment : MIELE / ELECTROLUX
- Laundry equipment : MIELE

OTHER

- SD Jacuzzi : RIVIERA POOL
- Pumps : BOMBAS AZCUE
- Fuel separator : ALFA LAVAL
- Exterior lighting : BCM
- Underwater lighting : CANTALUPI
- V-Sat : ORBIT
- Main & Upper salon doors : PCM
- Side exterior doors : FREEMAN
- ICCP & Anti-fouling system : CATHELCO
- Paint : AWLGRIP

TENDERS & TOYS

- 1 x NAUTICA RIB 22"
- 1 X NAUTICA RIB 15"
- 1 x VALIANT SOLAS RB 450 with 25 hp YAMAHA engine

BARAKA



BARAKA