

# LA PAUSA



26.22m (86') | FERRETTI | 2010/2020





MAIN DECK AFT DINING



MAIN DECK AFT DINING



FOREDECK SUNBATHING



SUN DECK SUNBATHING



SUN DECK DINING



SUN DECK





MAIN SALON AND COMPANION WAY



MAIN SALON



DINING



MASTER CABIN



MASTER CABIN BATHROOM



VIP CABIN



VIP CABIN BATHROOM



TWIN CABIN WITH PULLMAN



# GENERAL ARRANGEMENT

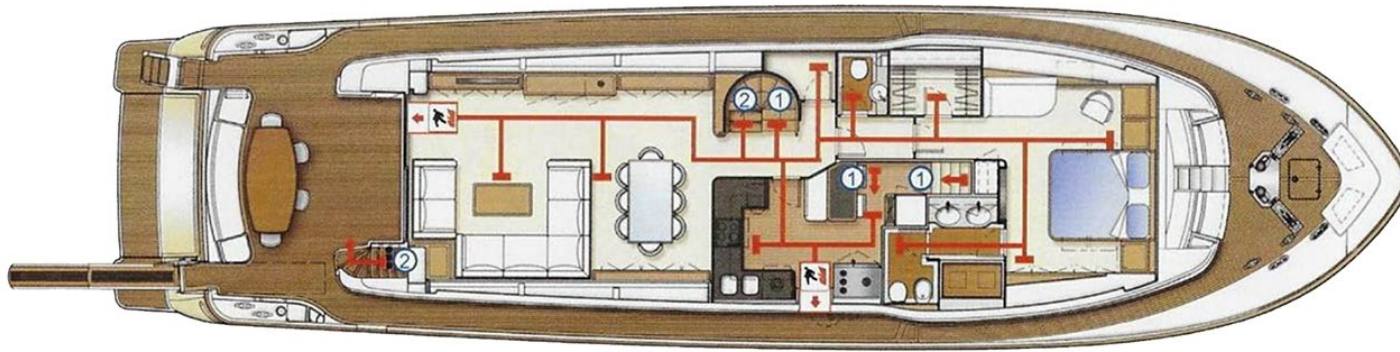

BRIDGE DECK

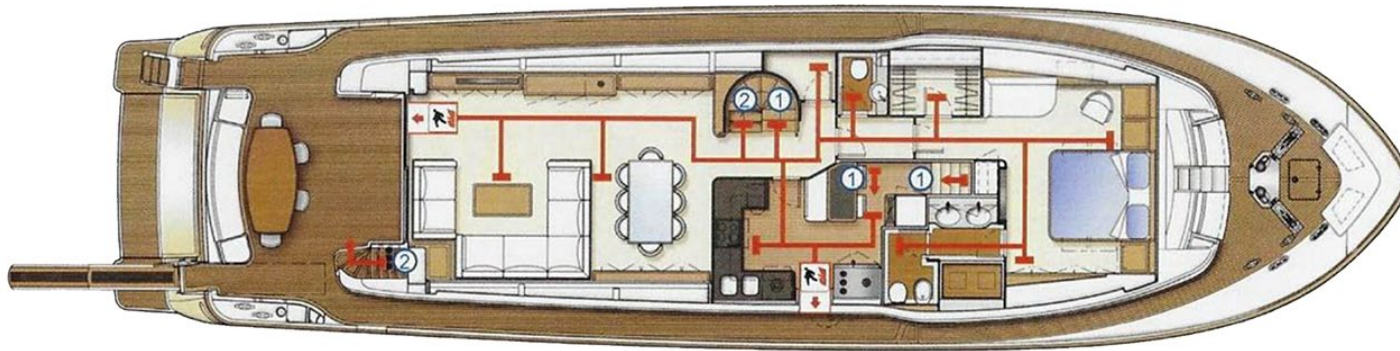

MAIN DECK



LOWER DECK

## SPECIFICATIONS

### DIMENSIONS

---

<b>Length</b>	26.22m (86')
<b>Beam</b>	6.93m (22'9")
<b>Draft</b>	2.16m (7'1")

### GENERAL

---

<b>Year</b>	2010/2020
<b>Builder</b>	Ferretti
<b>Exterior Design</b>	Zuccon Int. Project
<b>Interior Design</b>	Zuccon Int. Project
<b>Hull Construction</b>	GRP
<b>Superstructure</b>	GRP
<b>Gross Tonnage</b>	91

### ACCOMMODATION

---

<b>Number of Cabins</b>	5 - 1 Master Cabin, 1 VIP Cabin, 3 Twin Cabins (each with Pullman bed)
<b>Total Guests</b>	10/12
<b>Total Crew</b>	4
<b>Guest capacity for events</b>	35

### TECHNICAL INFORMATION

---

<b>Engines</b>	2 x 1100hp (2,200hp) MAN V10 CR
<b>Generators</b>	2 Köhler generators 28kW with soundproof casing
<b>Fuel Capacity</b>	12,000 litres
<b>Water Capacity</b>	2,000 litres
<b>Fuel Consumption</b>	150 litres per hour

<b>Range</b>	1,500 nm @ 12 knots
<b>Maximum Speed</b>	14 knots
<b>Cruising Speed</b>	12 knots
<b>Stabilisers</b>	At anchor and underway
<b>Navigation</b>	60 nautical miles from safe haven

### CERTIFICATIONS

---

<b>Flag</b>	Malta
<b>Port of Registry</b>	Valletta
<b>Class</b>	RINA

### TENDER AND TOYS

---

- 4.8m Zodiac Yachtline Tender 440 with 50hp - 6 pax
- 1 x Seabob F5 (2018)
- 1 x Electric foil board
- Water skis
- Snorkeling equipment
- Fishing equipment
- Inflatables

### VARIOUS

---

- Air Conditioning
- WiFi

### WEEKLY CHARTER RATES - MYBA TERMS

---

- €52,000 per week - High Season rate
- €44,000 per week - Low Season rate

