

LADY DEE

FOR CHARTER





MAIN DECK SALOON



MAIN DECK - FORMAL DINING



FULL BEAM MASTER CABIN - FORWARD ON THE MAIN DECK



MASTER EN SUITE BATH & SHOWER ROOM



MASTER SUITE - STUDY



MASTER SUITE - PRIVATE BALCONY



2 VIP SUITES WITH EN SUITE SHOWER - LOWER DECK

VIP - EN SUITE SHOWER





2 TWIN/DOUBLE CONVERTIBLE CABINS WITH EN SUITE SHOWER
(1 WITH EXTRA PULLMAN) - LOWER DECK

SKYLounge CONFIGURED AS A 6TH CABIN
SHOWER ROOM EN SUITE





MAIN DECK AFT



MAIN DECK AFT DINING



BRIDGE DECK AFT



SUN DECK



SUN DECK



SUN DECK AFT



THE GALLEY



THE BRIDGE

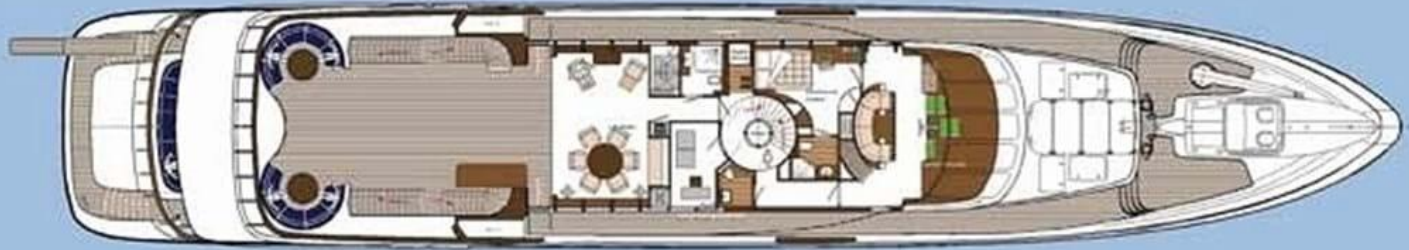

M/Y LADY DEE

Specification

Length	47.00m (154'2")
Beam	8.60m (28'3")
Draft	3.10m (10'2")
Build	Voorland - Holland
Interior Designer	Sue Canham
Year	2012
Cruising Speed	13.5 knots (maximum 14.5 knots)
Fuel Consumption	550 l/hr @ 13.5 knots

Crew 11

Guest Accommodation

10-12 Guests in 5-6 Cabins:

- Master cabin with bathroom en suite (tub & separate shower)
- 2 VIP cabins with shower room en suite
- 2 Convertible twin/double cabins with shower room en suite
- Sky lounge converts to double cabin upon request - with shower room en suite

Tenders & Toys

- 1 x 6.10m Naumatec tender with 2.8 diesel - 45 knots
- 1 x 3.6m Novourania tender with 40hp Yamaha
- 1 x Yamaha SuperJet 700 stand up jet ski (new 2019)
- 1 x Kawasaki 800 SXR stand up jet ski (new 2019)
- 2 x SeaDoo Spark jet skis
- 2 x one person tubes
- 1 x two person tube
- 1 x three person banana
- 2 x SUPs
- 2 x pairs of water skis
- Diving equipment

LADY DEE

