

E-BROCHURE

Malahne







Delivered in 1937 by Camper and Nicholsons to businessman and renowned yachtsman, William Lawrence Stephenson, MALAHNE roamed the globe before serving in World War II during which she participated in the evacuation of Dunkirk.





Later, MALAHNE was owned by film producer, Sam Spiegel, and became one of Hollywood's glittering jewels. She served as the production headquarters for the making of Lawrence of Arabia and also hosted stars such as Elizabeth Taylor, Grace Kelly, Frank Sinatra, Kirk Douglas and Jack Nicholson.





The design firm Oliver Laws, known for its work on the public and private rooms at Claridges in London, ensured that MALAHNE's interior, with its bespoke furniture, art and antique silver, pays homage to the grandest era of classic yachting









Recently relaunched by Pendennis Shipyard in a project led by Edmiston, MALAHNE has been meticulously restored to the glorious Art Deco style for which she is renowned while also being a thoroughly modern period piece



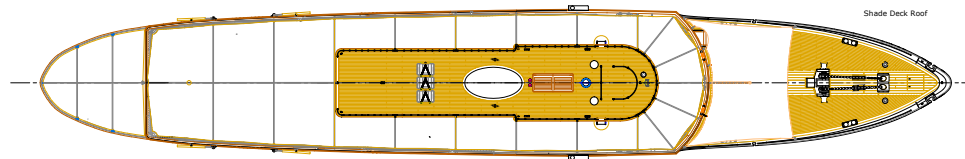
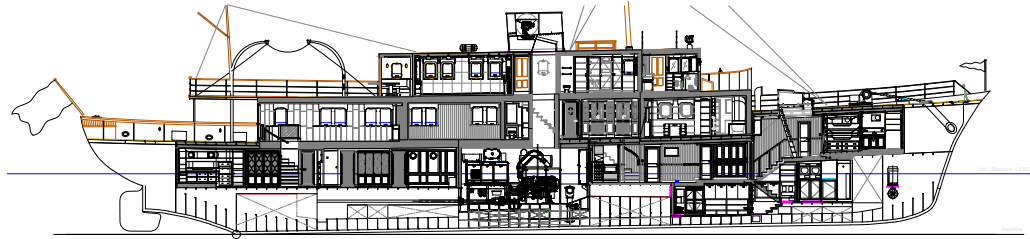
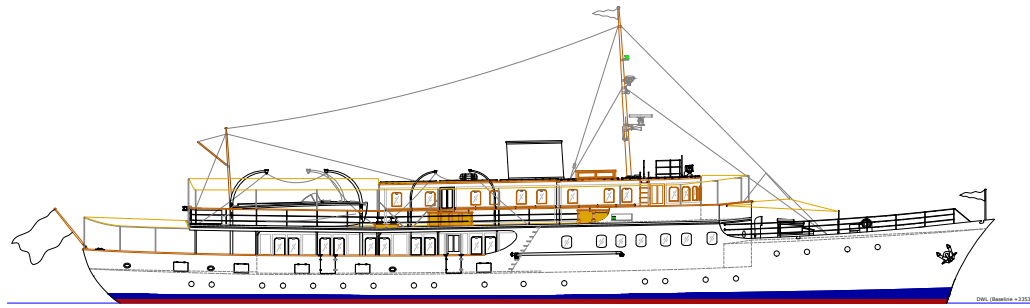

Shade Deck Roof

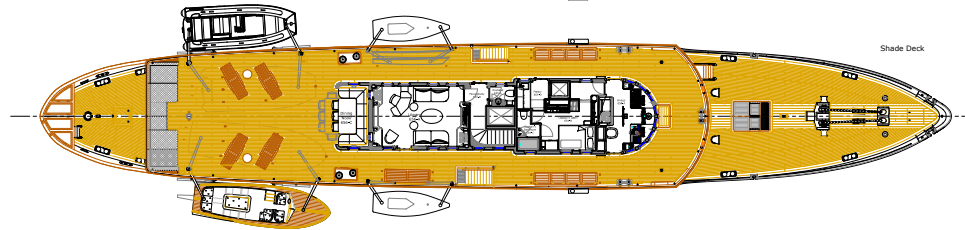

Shade Deck

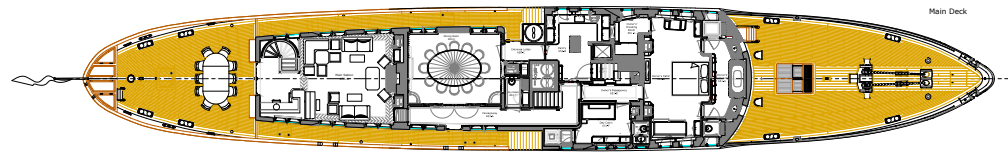

Main Deck



Cabin Deck

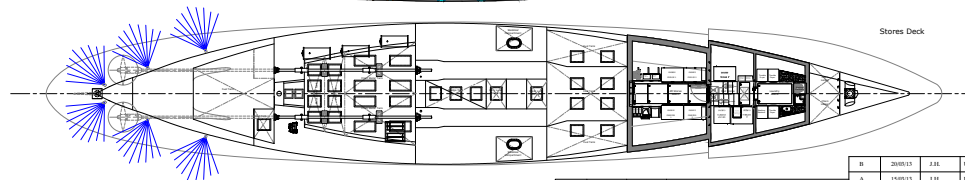

Stores Deck

B	20/01/13	2.01	Updated Engine room air tracks & associated areas
A	15/01/13	2.01	UPDATED



SPECIFICATIONS

MAIN CHARACTERISTICS

Builder: Camper & Nicholsons

LOA: 50.00m / 164'

Crew: 11

Built: 1937

Refit: 2015

Accommodation: 10 guests

Cabin configuration: 3 doubles, 2 singles, 1 twin

Speed: 12.5 knots

TENDER

1x 7.5m Custom Cockwells Varnished Mahogany High Speed
Owner's Launch (Summer only)

1x 6.25m Williams Jet tender

NB: The tenders can remain outboard of the vessel up
until force 4 conditions 1m swell.

TOYS

2x Laser Sailing dinghies

2x Lanikai II single Passenger Inflatable Kayak

1x Fanatic 75 Windsurfer Model 2015

2x Inflatable Paddle Boards

2x Waterskis

2x Wakeboards

1x Kneeboard

2x Towable Toys

2x Fishing Gear

10x Snorkeling Equipment

1x Go Pro Hero 4 camera + Accessories

8x Swimming Equipment

1x 2-person inflatable kayak

FEATURES

Interior Design by Oliver Laws

Quantum zero speed stabilizers

47" HD TV in the Owner's cabin concealed in cabinetry

42" HD TV in upper deck library concealed in cabinetry

Central movie database with approx 200 movies shown
through Apple TV

No Sat TV

Apple iPads in all the cabins with Bose cordless
headphones connected to movie database for individual
viewing

DECT cordless phones in public areas and 1930's custom
phones in all guest areas through a Panasonic digital
exchange

Dumb waiter serving all decks



Advertising of the above vessel in either printed publications on the internet or in any other medium
is not permitted without prior permission from the Owner via the Central Agent.

All particulars are given in good faith and are believed to be correct but cannot be guaranteed.