



NEXUS

SUNSEEKER YACHTS • 40.05M • 2019

BUILDER SUNSEEKER

YEAR 2019

LENGTH 40.05 M

BEAM 8.09 M

DRAFT 2.85 M

CRUISING SPEED 14 KN

MAX SPEED 20 KN











MAIN SALON



MAIN SALON



DINING AREA



MASTER CABIN



MASTER CABIN



MASTER CABIN



MASTER BATHROOM



UPPER DECK



UPPER DECK AFT



UPPER SALON



UPPER SALON



BRIDGE



LOWER DECK



DOUBLE GUEST CABIN

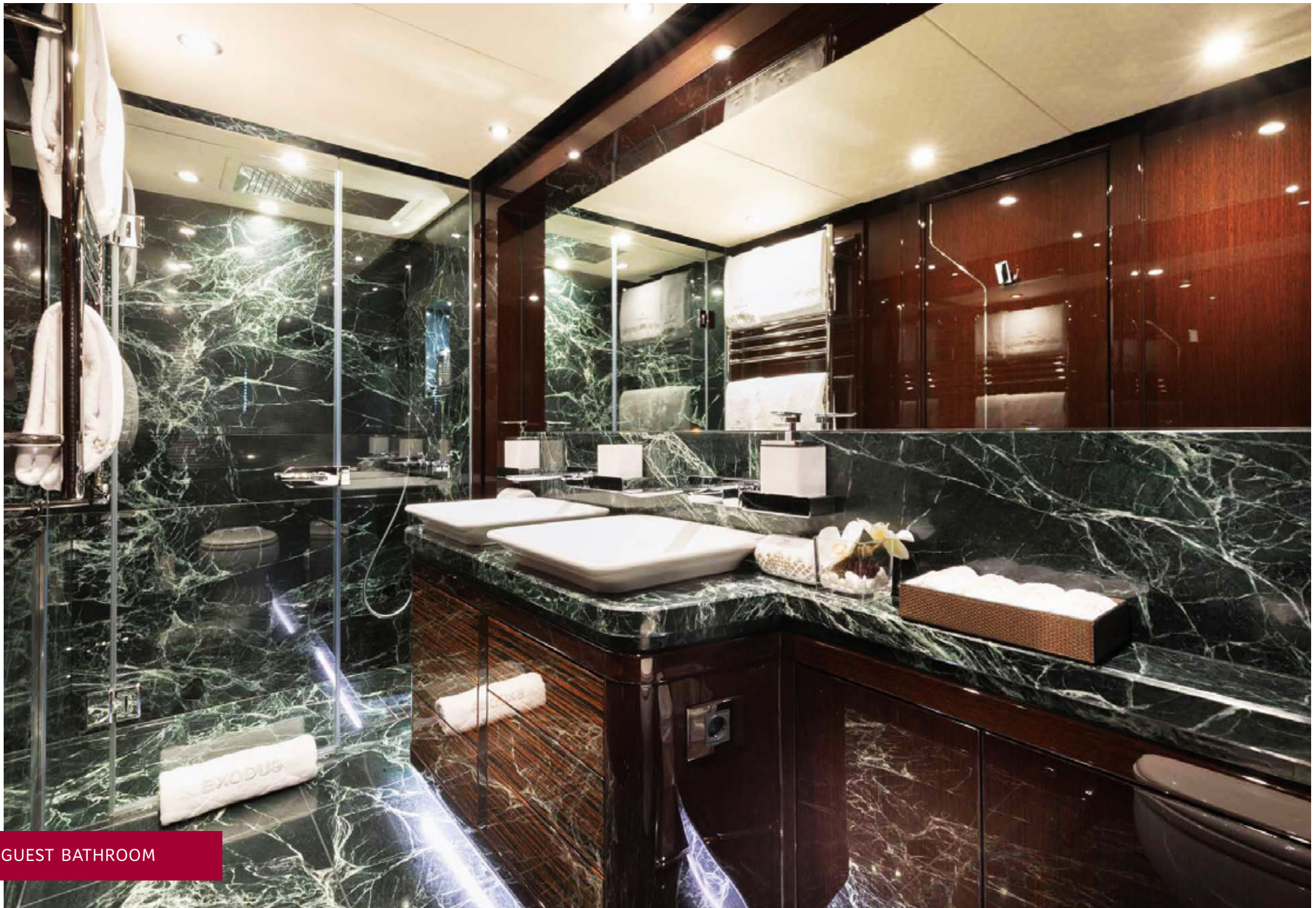

GUEST BATHROOM



DOUBLE GUEST CABIN



GUEST BATHROOM



TWIN GUEST CABIN



GUEST BATHROOM



SUNDECK

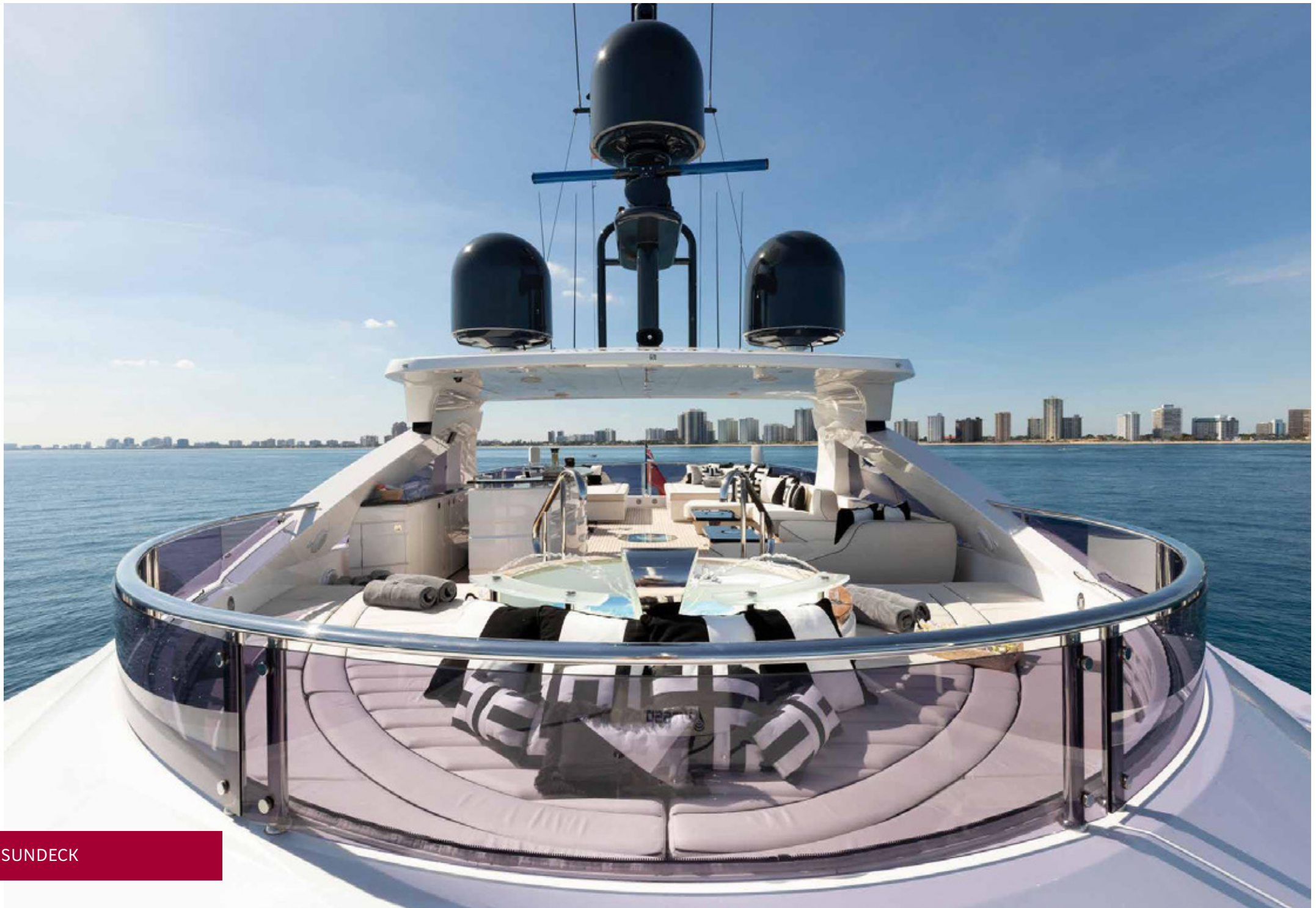

SUNDECK



JACUZZI



SUNDECK



SUNDECK

SPECIFICATIONS

Overview

Yacht Type	Motor Yacht
Builder	Sunseeker
Year Built	2019
Length	40.05 metres
Beam	8.09 metres
Draft	2.85 metres
Exterior Designer	Sunseeker
Interior Designer	Sunseeker
Flag	Cayman Islands

Performance & Capacities

Max Speed	20 kn
Cruising Speed	14 kn (est.)
Engines	2 x MTU 12V 4000 M93
Generators	2 x Kohler 80 kW
Fuel consumption	420 l/h at 14kn
Range	1200
Gross tonnage	343 tons

Materials

Hull	GRP
Superstructure:	GRP
Deck:	Teak laid on GRP

Accommodation

Cabins	5
Cabin configuration	3 double, 2 twin
Guests sleeping	12
Guests cruising	12
Crew	8

Tender & Toys

- Tender: Williams Dieseljet 565, Length: 5.65 meters with inboard engine, 5 guests comfortably. Can reach top speed up to 70 km/h.
- 2 x Sea-Doo RXP-X 300 with Venom Custom Tuning Package - Wave Runner Trackers fitted linked to the vessels bridge navigation systems
- 2 x Sea Bob F5 SR

LAYOUTS

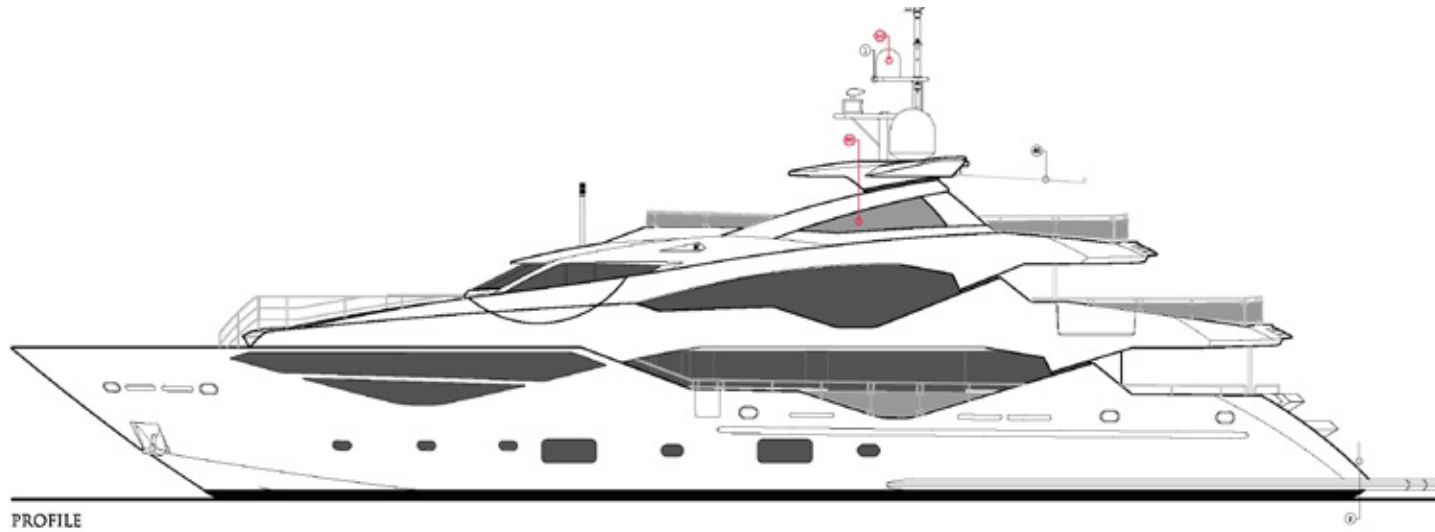

PROFILE

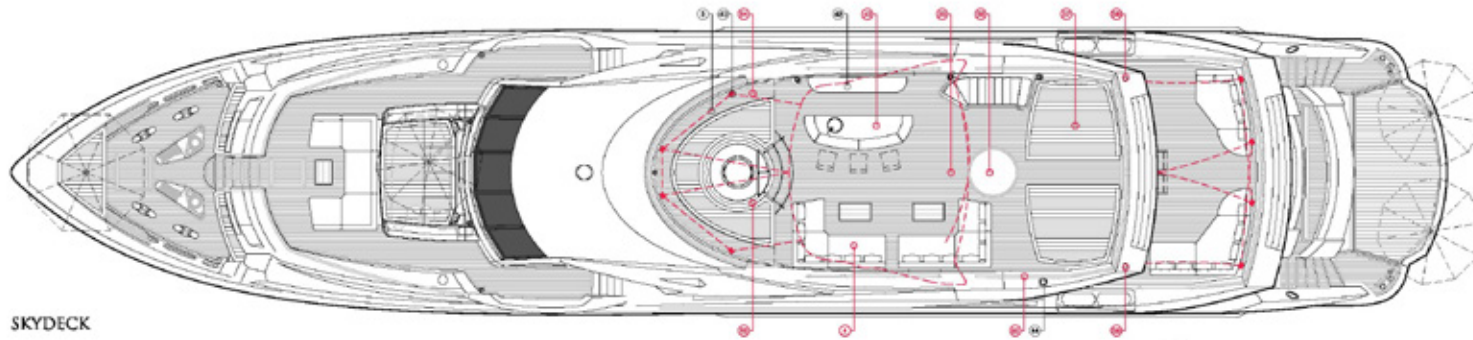

SKYDECK

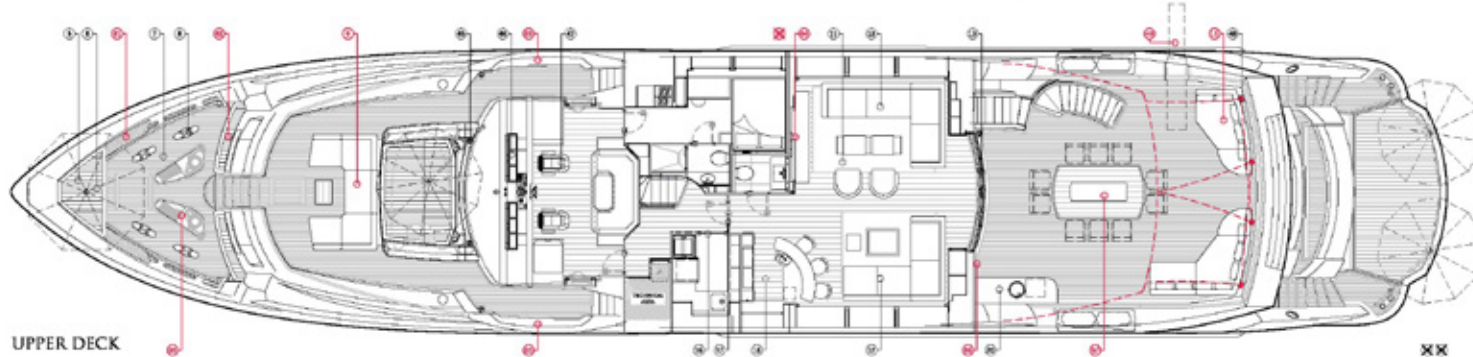

UPPER DECK

LAYOUTS

MAIN DECK

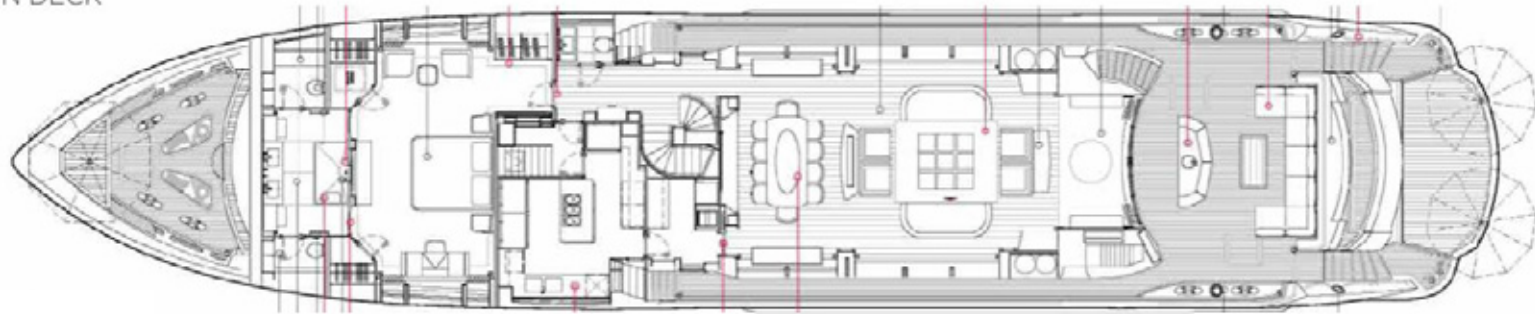

LOWER DECK

