

E-BROCHURE

Soundwave







Soundwave is an entertainer's dream with endless options for spending time outdoors across her impressive deck spaces. Her sun deck aft offers a resort style experience with an English spa-inspired pool, generous sunbathing areas sheltered by umbrellas and a fluted bar complete with seating and low-level tables. On her upper deck aft, there is an exceptional dining space for an al fresco experience, with a 14-seat table, accompanied by an outdoor bar, and on her main deck there is a beautiful teak deck and custom-fitted seating area sheltered by her awning.







Soundwave features an Art Deco-inspired interior, brought to life by Candy & Candy. Throughout she features geometric shapes, stepped forms and intricate line art which is accented by polished stainless-steel finishes, bespoke chandeliers, and flawless Italian marble. The Main Salon provides an impressive living and entertaining space, complete with a custom-made U-shape sofa with 10 generous seat cushions along with a 12-seater formal dining table. The sky lounge on the upper deck provides a relaxed area, with an informal sofa setting and custom-made cocktail bar.







Soundwave has accommodation for up to 12 guests across six cabins with a luxurious Master suite on the upper deck that includes an expansive 180-degree panoramic view over the bow of the boat, overlooking a private pool and fore deck area. Her second Master suite on the main deck is complete with spacious interiors and expanses of windows allowing natural light to flow into the space along with a study, powder room and walk-in dressing area. The remainder of guests are accommodated across two double cabins and two twin convertible cabins, all with ensuite.





































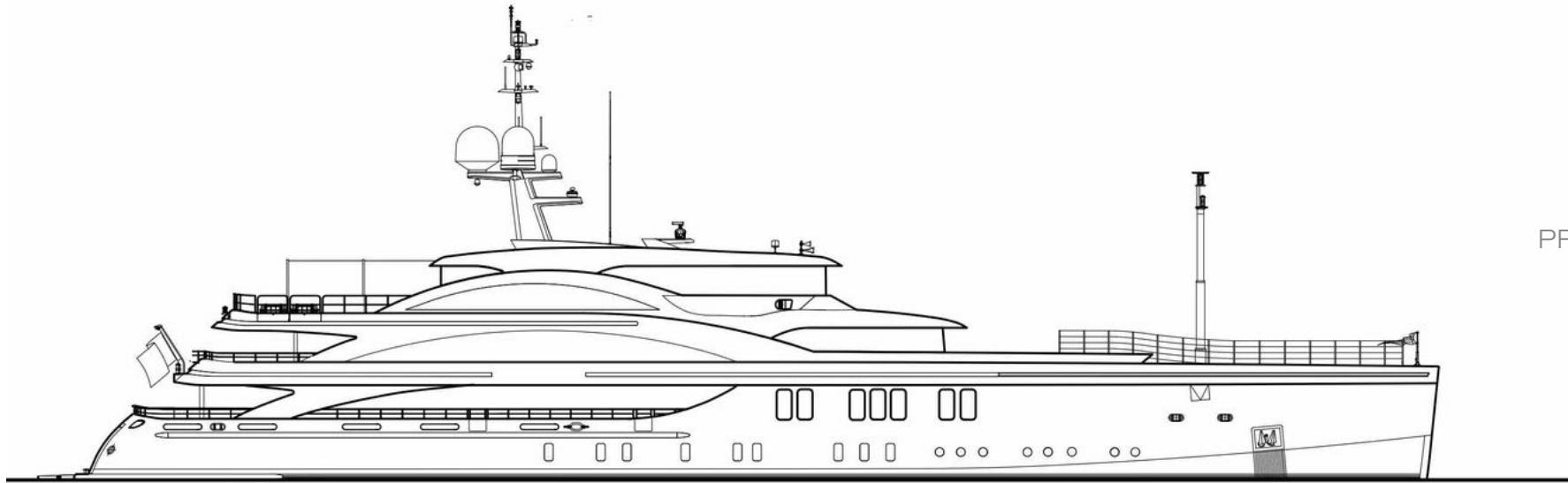

PROFILE

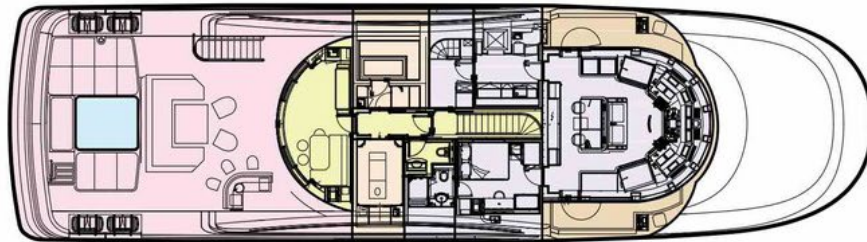

SUN DECK

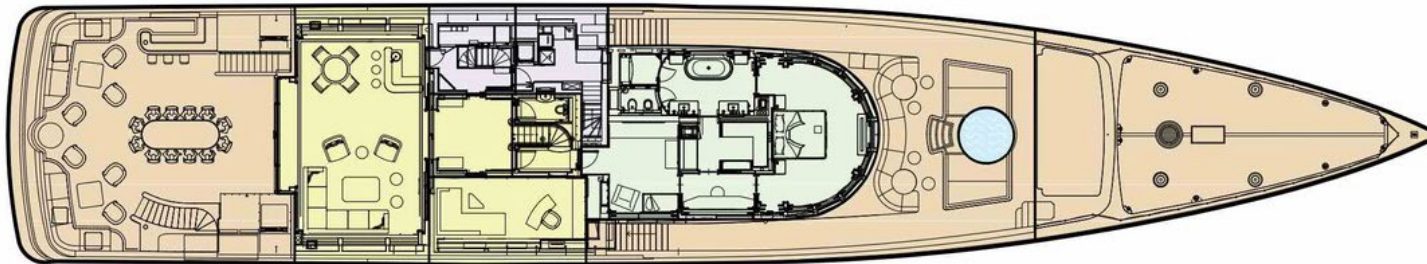

UPPER DECK

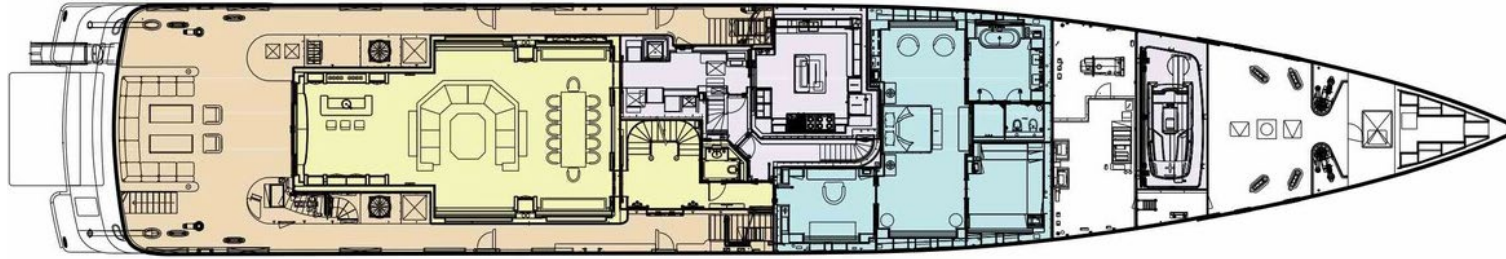

MAIN DECK

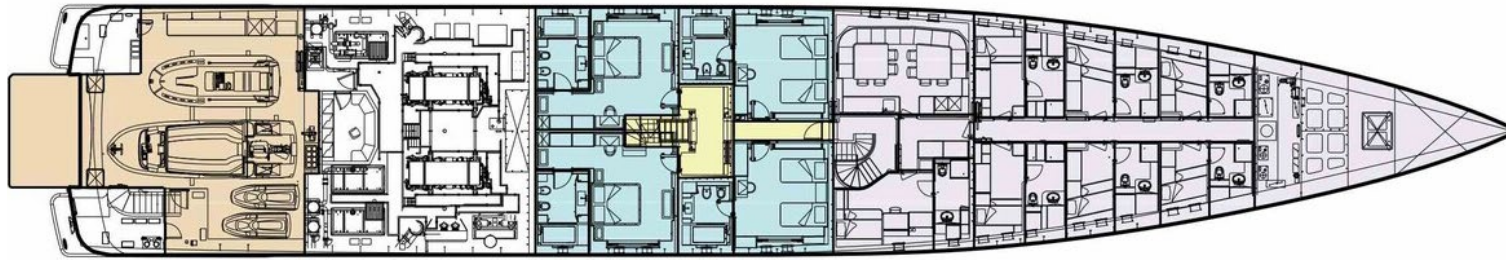

LOWER DECK

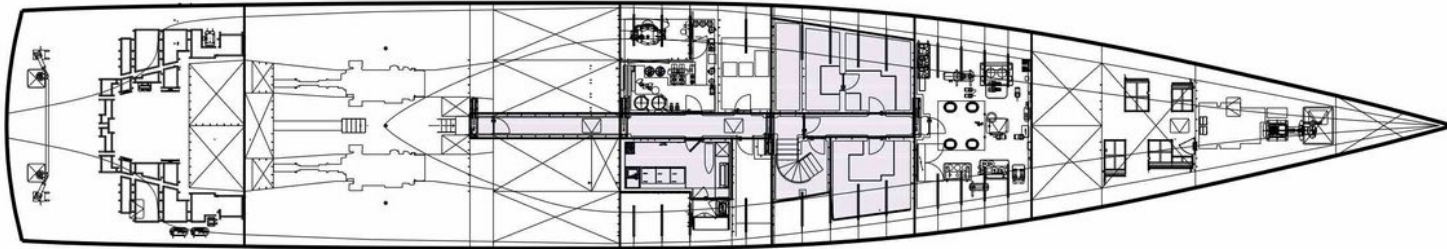

TANK DECK



SPECIFICATIONS

MAIN CHARACTERISTICS

Builder: Benetti SpA
LOA: 63m (206' 8")
Crew: 15
Built: 2015
Refit: 2025
Accommodation: 12
Cabin configuration: 4 doubles, 2 twin (convertible)
Cruising speed: 14 knots

DECK GAMES

Big Jenga
Pétanque
Corn hole
Volleyball
Football
Rugby
2 x Golf club sets (1 x adult & 1 x child) with dissolvable golf balls & turf platform

TENDER

8.0m Custom Limo (360hp)
6.0m Novurania Launch (260hp)
4.5m Castoldi rescue/crew tender

TOYS

1 x Flyboard (for experienced riders)
2 x Seadoo 215hp GTX
3 x Seabobs
2 x Double kayaks
4 x Paddle boards
1 x Wakeboard (small & large bindings)
1 x Wake foiler
2 x Knee boards
1 x Adult & kids waterskis
1 x Windsurfer
1 x Windsurfer Bic (learner & professional sails)
2 x Kids underwater scooters
4 x Learner surfboards
1 x Aquaglide trampoline for kids
1 x Jelly fish pool
Waterslide from foredeck
Climbing wall
Fishing gear
Portable BBQ for use on front decks and stern platform
Towable toys (2 x Malibu donuts, 4-person couch, Wow Eagle)

Advertising of the above vessel in either printed publications on the internet or in any other medium is not permitted without prior permission from the Owner via the Central Agent.

All particulars are given in good faith and are believed to be correct but cannot be guaranteed.