



STARFIRE
Imagine

Charter excellence at sea



11 00



Imagine approaching **STARFIRE**, noticing its smiling crew, welcoming you on board...

1130



savoring your first sip as you embrace the start of a new adventure ...

A person is seen from behind, standing on the deck of a white boat. They are wearing a white, long-sleeved shirt with a decorative, circular embroidery on the back. They are also wearing a wide-brimmed, light green straw hat. Their right hand is raised to the top of the hat, and their left hand is holding a drink with a yellow straw. The background shows a clear blue sky, a turquoise sea, and a small, green island in the distance. A white mast is visible on the left side of the boat. In the bottom right corner, there is a small, stylized white logo.

1230

finding that little nook that will soon become your hidden gem ...

14 000



taking your first plunge, discovering the natural wonders of the sea ...

15 30



enjoying your first well-deserved rest in months under the shimmering afternoon sun ...

17 00



leaving all your worries behind as you find your inner peace ...

20 00



loving every flavor and spice revealed as you delight in its presentation ...



22 00



finishing the night off watching your favorite stars under the evening lights ...

23 30



finally sleeping with nothing on your mind other than the pleasures of a day at sea ...



The **STARFIRE** Lifestyle. Welcome aboard.

DISCOVER



S T A R F I R E



ENJOY

Let yourself unwind in comfort.



Sun Deck





2
Upper Deck

3

Main Deck



PLAY

Let your inner child win you over.





SAVOR

Let your taste buds take pleasure in every bite.





SLEEP

Let yourself rest and revitalize.

1

Master Cabin

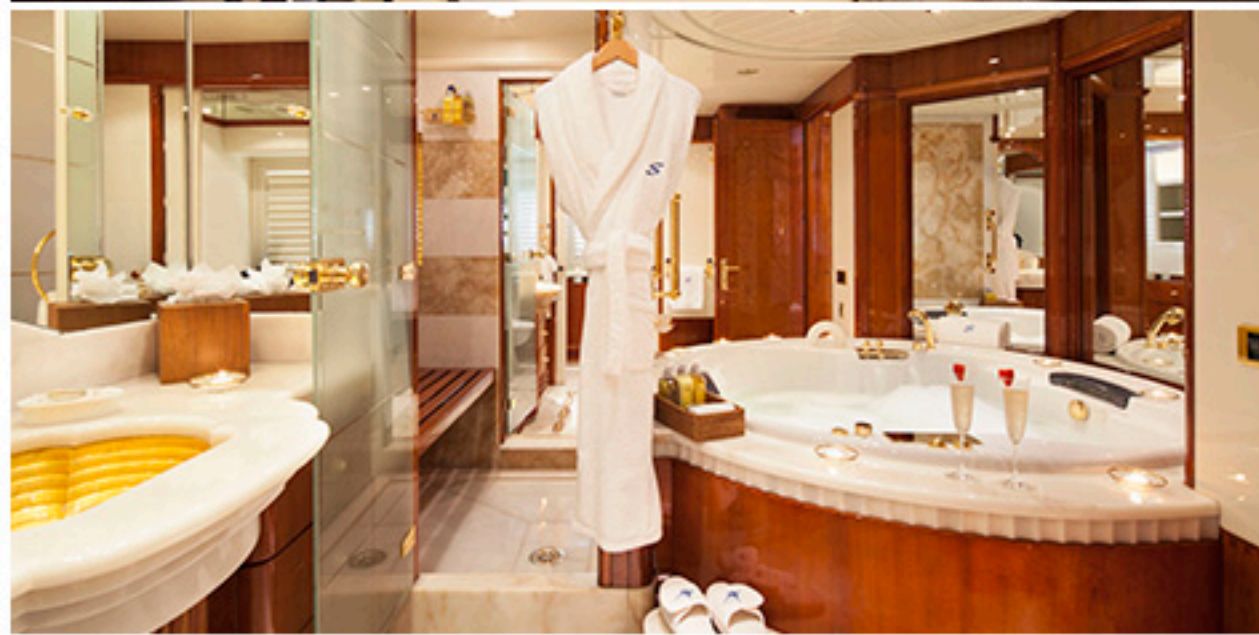

2

VIP Cabin



3

Guest Queen
Cabin



4

Guest Twin
Cabin



CREW

Let yourself be pampered with style.



CAPTAIN

STARFIRE's Captain was born into yachting. His first words were "Danforth Anchor". Carl, his Dad and his Brother have a combined 840,000 nautical miles as Men of the Sea. Winning "Best Captain" accolades, jet and water skiing his way across the globe, flying helicopters and creating a "no problems only solutions" atmosphere is his mission.

Captain Carl was the individual winner as "Best Captain of a Mega Yacht in 2001" at the Ft. Lauderdale International Boat Show. This accolade was given for his ability to be a "can do" positive leader of a CREW where a "no problems only solutions" attitude prevails.





You, as a Guest, might notice them climbing the mast to change the courtesy flag, polishing the stainless handrails to a blinding gleam, or assisting the Captain with moving the vessel... ultimately, the mission of STARFIRE's Deck Crew is to provide you with safe passage from port to port in total comfort throughout your stay.

The Deck Crew can also be counted on for some fun in the sun. They will facilitate your entertainment with jet skis, wakeboards, kayaks, ski bobs, STARFIRE's Hinckley tender or a cocktail on a secluded beach. They are the keepers of the hidden island gems... the secret beach hideouts.



INTERIOR CREW



While onboard STARFIRE, you might perceive a hint of magic ... your bed is always perfectly made, your clothes are always put away and your glasses are always in reach. Flowers and chocolate decorate your bed at night, a glass of champagne magically appears in your hand before dinner and your favorite song suddenly resonates throughout the sundeck.

What appears to be magic is the result of great collaboration between the members of STARFIRE's spot-on team of Stewardesses. It is their pleasure to accomplish the impossible on your STARFIRE holiday!



CULINARY CREW



While pondering the idea of chartering STARFIRE, you might dream of white beaches, turquoise clear waters, a luxurious cabin, sun-soaking relaxation and fun. Yet, when you leave STARFIRE all you can think about is getting that oh-so-divine recipe from STARFIRE's talented culinary Chefs, Stuart and Jesse!

Special requests are always met with rave reviews. STARFIRE's Chefs will only be satisfied if they fulfill all of your personal dietary dreams.





ENGINEERING CREW



As your first step onboard STARFIRE, you will briefly meet Nick and Hewert, then you might only see them once more when you are just about to step off STARFIRE for the very last time. When you do, you might think to ask them where they have been for all this time... They will laugh and say "don't mistake it, we have been around".

STARFIRE is a technical wonder of mechanical, electrical and navigation systems. Nick and Hewert maintain every system so that you, STARFIRE's Guest, remain safe and comfortable. They rotate in a 24 hour watch schedule to make sure that STARFIRE is always running at a level of peak performance.

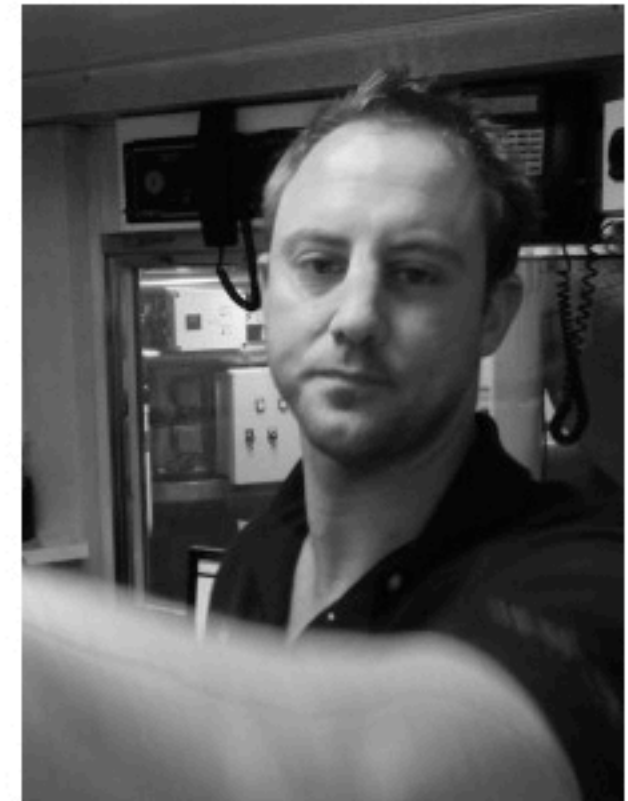

STARFIRE

The benchmark of Yachting Excellence.

AT-A-GLANCE



Captain: **Carl Sputh**
Safe Nautical Miles: 180 000+



12 Crew Members
Safe Nautical Miles: 1.2 Million

DESTINATIONS



IN NUMBERS

Launch Year: 1998

Builder (Italy): Benetti

Style: Modern, Art Deco

Interior Designer: Francois Zuretti

Refit: 2002, 2004 & 2012

Length: 178' (54m)

Beam: 31.5' (9.6m)

Draft: 11.6' (3.5m)

Tonnage: 757

Maximum Speed: 15 kts

Cruise Speed: 12 kts

Fuel Capacity: 35 000 gal (140 000 L)

Hull: Steel

Superstructure: Aluminium

At Anchor Stabilizer

Ku-Ban Satellite: High Speed WiFi

Audio System: State-of-the-art

WET

Main tender
36 ft Jet Drive Hinckley



Crew tender
15 ft Nautica



Kayak
One Person



Kayak x2
Two Person



Jet Skis x2
Wave Runners Kawasaki 850cc



Water Toy x2
Seabobs



Water Toy
Trampoline



Water Toy
Tow Tubes



Water Toy
snorkeling Equipment



Water Toy
5 Person Toboggan



Water Toy
Wakeboard



Water Toy
skies



HEALTH

Relax
Massage Room



Relax
Jacuzzi



Relax
Sauna



Fitness
Yoga Mats



Fitness
Assorted Weights



Fitness
Workout Bands



Fitness
Treadmill



Fitness
Recumbent Bike



Fitness
Elliptical



LAYOUT

Sun Deck

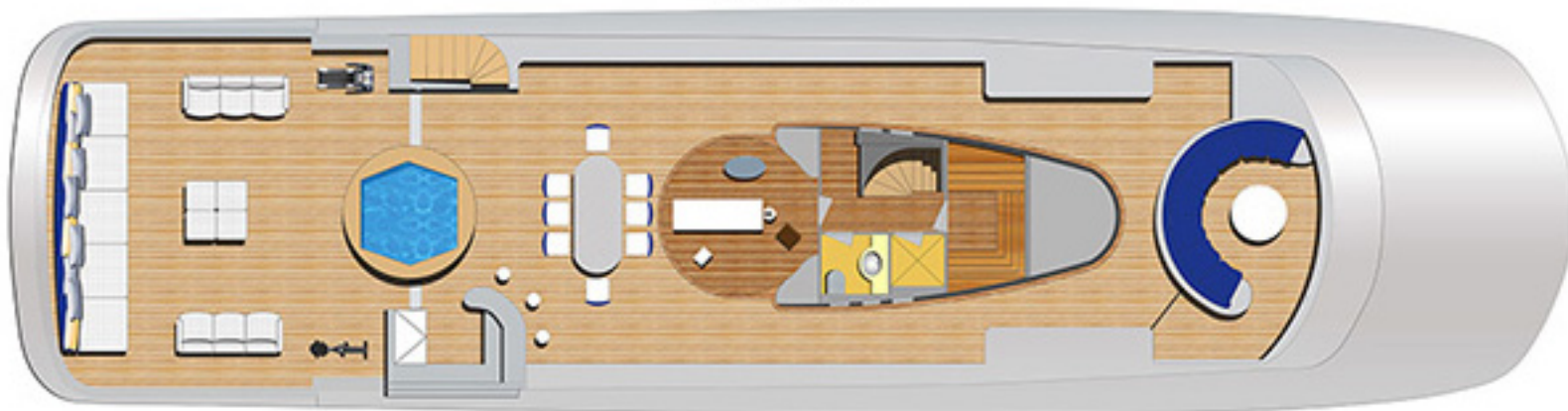

Upper Deck



Main Deck



Lower Deck

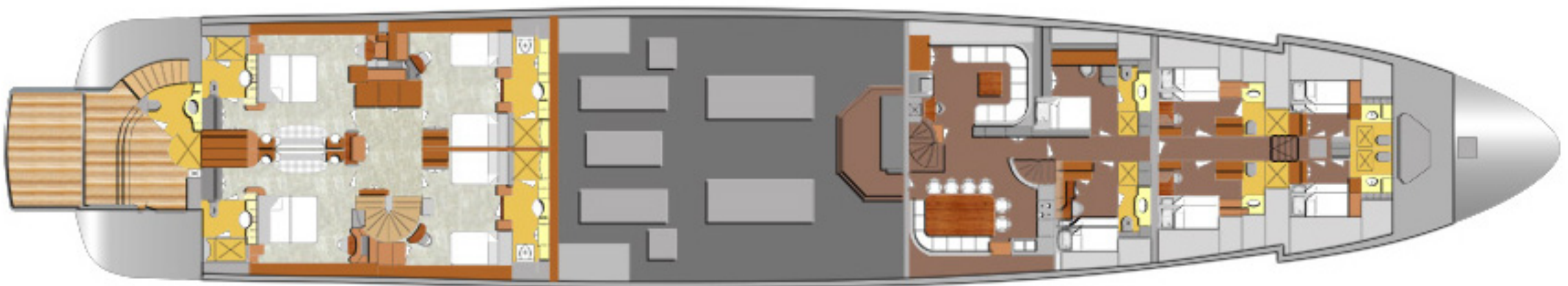



S T A R F I R E

Contact your broker to experience the dream.

Captain Carl Spath.