

T E L E O S T



T E L E O S T

F O R C H A R T E R



T E L E O S T

Lovingly cared for by her dedicated crew, TELEOST is in impeccable condition and family-friendly with a whole host of exciting features, TELEOST is in high demand on the charter market.

OVERVIEW

TELEOST has been through a refit in 2023. Built for adventure, TELEOST cruises comfortably at 11 knots and is capable of taking you to the world's most remote regions. She has a first-class crew of 10 onboard and an endless array of luxury amenities to ensure an unforgettable charter experience.

GUEST CAPACITY

Spacious and comfortable, TELEOST has accommodation for up to 12 guests in 5 generously-sized double staterooms. Classically elegant, each of the staterooms is equipped with a home entertainment system and opens into a private ensuite bathroom. Her full-beam master suite is located on the main deck and features a private lounge area plus a spa pool for relaxation. The guest accommodation can be found on the lower deck and is made up of 2 double and 2 twin cabins. TELEOST also has accommodation for her professional and experienced crew of 10 on the lower deck.

S P E C I F I C A T I O N S

49.07M | FEADSHIP | 1998/2023

 LENGTH 49.07m BEAM 8.51m NO. OF GUESTS 10 MAX SPEED 14 kts GUEST CABINS 5 RANGE 4,500nm

I N T E R I O R

Styled by UK-based designer John Munford, TELEOST's vast interior is a modern classic. Polished mahogany panelling is paired with silk window panels and chic neutral furnishings to create a luxurious setting to relax and socialise. The large main salon is an elegant and comfortable space to spend time with family and friends. Huge windows overlook your destination and fill the room with natural light. Equipped with a full entertainment system, the salon also has a huge selection of music, games and books for guests to enjoy.

E X T E R I O R

With her vast decks plus multiple lounge and dining areas, TELEOST is designed to take outdoor living to the next level. Created by Studio De Voogt, TELEOST's distinct profile and open-plan exterior layout give her a perfectly balanced signature on the water. The aft deck has an outdoor dining area and bar plus built-in seating for after-dinner lounging. In the stern, TELEOST has a vast custom swim platform with an outside shower and a swim ladder. The perfect launchpad for the extensive collection of water toys.























































TOYS & TENDERS

TOYS, EQUIPMENT & ACCESSORIES

- 2 ft/6.95 m centre console Zodiac Open 7 with Yamaha 250hp outboard engine (a perfect platform for diving, fishing and watersports). Max capacity 16, including crew
- 20 ft /6.32m Williams 625 Dieseljet RIB with a Yanmar 6BY3 260hp Diesel inboard engine. Max capacity 11, including crew
- 2 x eFoils (Lift Foils 5'6" boards)
- 2 x 3-man Yamaha wave runners (4 stroke)
- 2 x Seabob F5S
- 2 x Red Paddle Co. Inflatable paddleboards
- 1 x Red Paddle Co. Inflatable Windsurf board (can also be used as paddleboard)
- 1 x Inflatable Paddle Board
- Snorkeling gear
- 4 x Wakeboards
- 1 x Wake surf board
- 1 x Wake skate board
- 3 x pairs of waterskis (S/M, L & children)
- 2 x Individual slalom waterskis
- Assorted inflatable toys (hot dog towable, 2 x donut ring inflatables, 1 x Large Mable couch inflatable)
- Extensive fishing gear
- 2 x Single and 2 x Double Kayaks
- 1 x double pedal / paddle Hobie kayak
- 5m Custom waterslide
- Assorted beach toys (pool noodles, bat & ball, volleyball, waterguns etc.)

S P E C I F I C A T I O N S

AUDIO-VISUAL & DECK EQUIPMENT

- Completely streaming of Blu-Ray & HD DVD Video-on-Demand system and upgraded TV panels in all guest cabins and Skylounge
- Plex Media Server with onboard media library of the latest Movies & TV Shows
- Crestron control system running on Samsung tablets
- High Availability Synology NAS storage system
- Airplay & HDMI Input for streaming personal content
- Plexus Direct TV (US West Coast region) for live TV
- Sonos Audio System in guest cabins and public areas
- Master cabin with SAT TV (American channels)
- Main Salon: Entertainment centre includes CD & Integrated Music System with MP3 input facility. Board games, movie and book libraries.
- Dining Salon: Forward, formal seating for 12. May be enclosed with partitioning door. Forward day head.
- Aft deck: Ample, built-in stern seating with dining for 12. Smoking permitted.

AUDIO-VISUAL & DECK EQUIPMENT (CTD.)

- Skylounge: SAT TV + Entertainment centre includes DVD, Blu-Ray, VCR, CD, Karaoke and Integrated Music System with MP3 input facility. 75inch 4k LED TV fitted for DVD/Blu-Ray playback with facility for Laptop input (HDMI/Composite Video). Wet bar and day head forward, Dining for 12 with retractable awning.
- Sun Deck: Integrated Music System, Jacuzzi, wet bar with 4 stools, built-in stern seating, awnings, BBQ, 4 x sunbeds and 4 x sun chairs.
- Master cabin and sky lounge with SAT TV (American channels)
- Boarding and water access: Passerelle (stern) boarding and side boarding. Custom swim platform with ladder to water and outside shower; extensive BBQ Grill; day head and shower within adjacent lazarette.

C O M M U N I C A T I O N S

- Starlink, WIFI, Satcom & cell phone/fax
- Master cabin and sky lounge with SAT TV (American channels)

REFIT/MAINTENANCE

- Winter 2022 – 2023: Complete exterior paint system, full exterior varnish refinishing, all new exterior deckheads and custom LED exterior lighting system with updated control system, new exterior soft furnishings, extensive interior woodwork refinishing throughout guest areas to original specifications, new interior deckheads and blinds where required in guest areas, updated on demand audio-visual system and onboard computer network, tenders updated with new cushions and furnishings along with extensive refinishing, two new 2023 Yamaha Waverunners (3-person), new inflatable water slide and updated water toys, new generators that meet the latest low emission standards, new electrical system including shore power convertor, new sewage system to meet the latest standards.
- Winter 2017 – 2018: Mechanical, Full Exterior Cosmetic Paint, New Air Conditioning system, new water-makers and new Jacuzzi. Full re-paint. Interior woodwork repairs and refinishing. Sat-Com upgrades (Kymeta flat panel satellite antennas installed, a new V-Sat antenna installed) upgraded 4G connections. Exterior soft furnishings re-covered.
- Winter 2012-2013: Mechanical, Full Exterior Cosmetic Paint, Interior Facelift (Every existing soft furnishings, carpets, headliner, drapes, curtains, furniture is being replaced, including lights and minor changes to wood trim).
- Winter 2007-08 refit: full re-paint, new fabrics in the cabins
- 2002 Refit including a full paint job.

SUNDECK

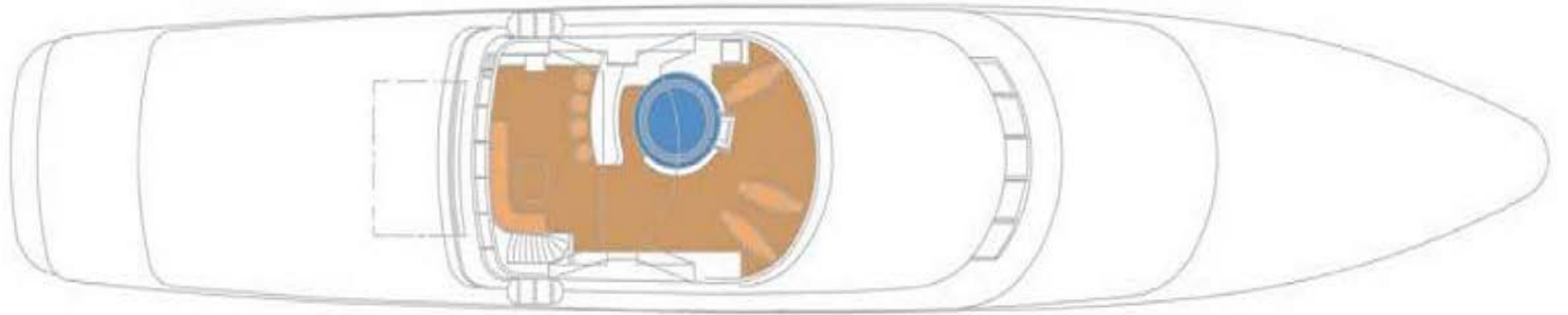

UPPER DECK

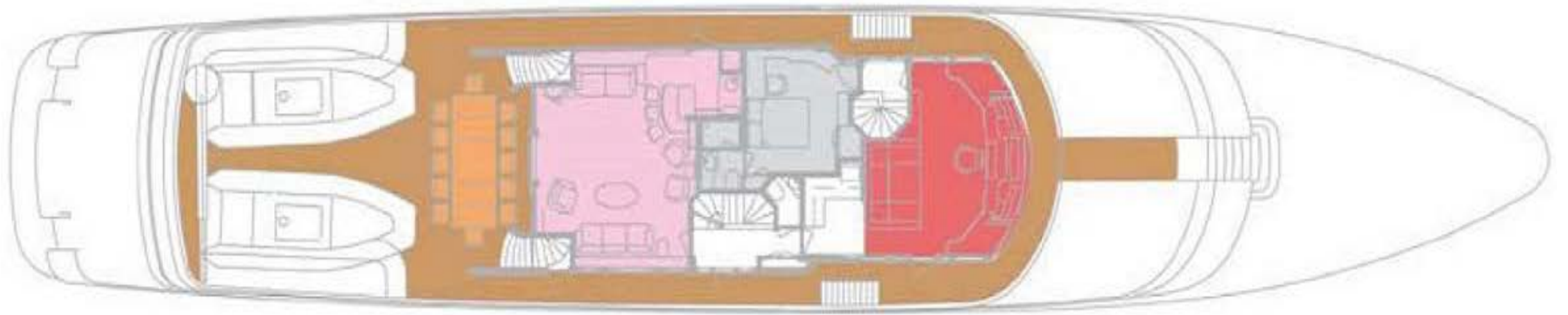

MAIN DECK

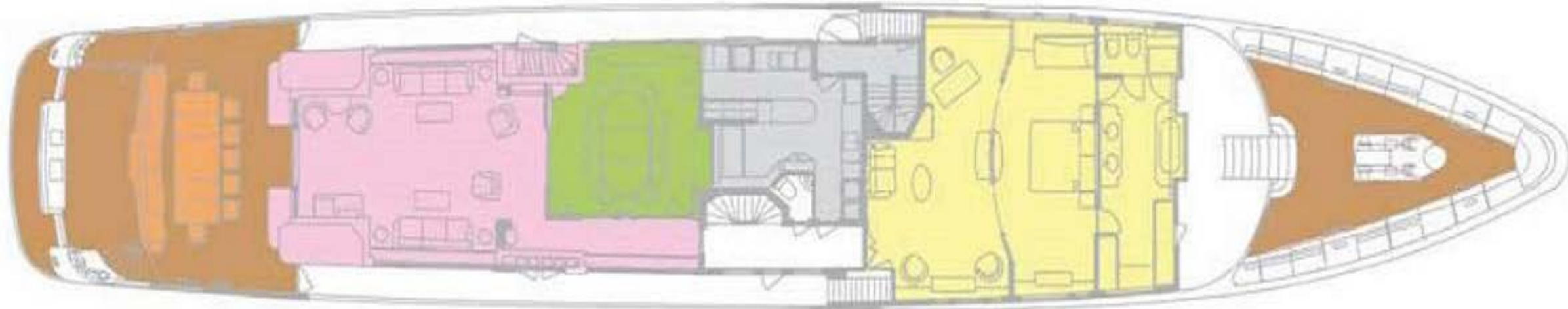

LOWER DECK

