



TWIZZLE



PERFECTION  
UNDER SAIL

AN INNOVATIVE  
LAYOUT ENHANCING  
SPACE AND COMFORT

Twizzle's design takes natural light and freedom of movement to create a calm and peaceful environment.





THE EMBODIMENT  
OF A REFINED  
UNDERSTATED  
AESTHETIC





EVERY EYELINE CAREFULLY CONSIDERED





## A UNIQUE BLEND OF INDOOR AND OUTDOOR DINING

Twizzle offers its guests three imaginatively conceived dining areas giving you the opportunity to choose surroundings that always reflect your mood.





ACRES OF  
BILLOWING  
SAILS HOISTED  
IN MINUTES



ELEGANCE  
AND POWER  
IN PERFECT  
HARMONY





## UNRIVALLED TRANQUILLITY AND HOSPITALITY

Up to nine guests can enjoy the Twizzle experience in three doubles, one twin and one pullman cabin, plus a large master suite with a bathroom, spa shower and private study en suite.





## COMFORT AND LUXURY WITHOUT COMPROMISE

An inspirational blend of natural colour and texture resulting in an understated and refined aesthetic. Cashmere throws, soft leather, woven linens and hand painted silks, acid washed oak boards, chocolate lacquer and pale polished marble in the bathrooms – ultimate luxury in a contemporary environment.





## A SAILING YACHT FOR SPEED AND EXHILARATION

Twizzle's innovative and hi-tech design has produced a yacht that excels at racing in all wind speeds and directions but is also perfect for cruising the world, even in the shallowest waters.





## LIFESTYLE AFLOAT

Sweeping teak decks carefully designed to offer the opportunity to sit back, relax and enjoy uninterrupted views across the sea, as Twizzle effortlessly glides through the ocean.





## THE OCEAN EXPERIENCE

Twizzle's design and engineering makes it the perfect yacht for those who love to kayak, swim, sail, fish, snorkel or dive. An ingenious swim platform has been conceived to allow it to open at any level above the ocean, depending on the sea's condition.





## BREATHTAKING FREEDOM

Twizzle has been created to sail. Her ground breaking innovative design means limitless sailing and exploration, giving you the opportunity to discover the world's hidden treasures.





UNPARALLELED  
TECHNOLOGY  
AND DESIGN  
INNOVATION



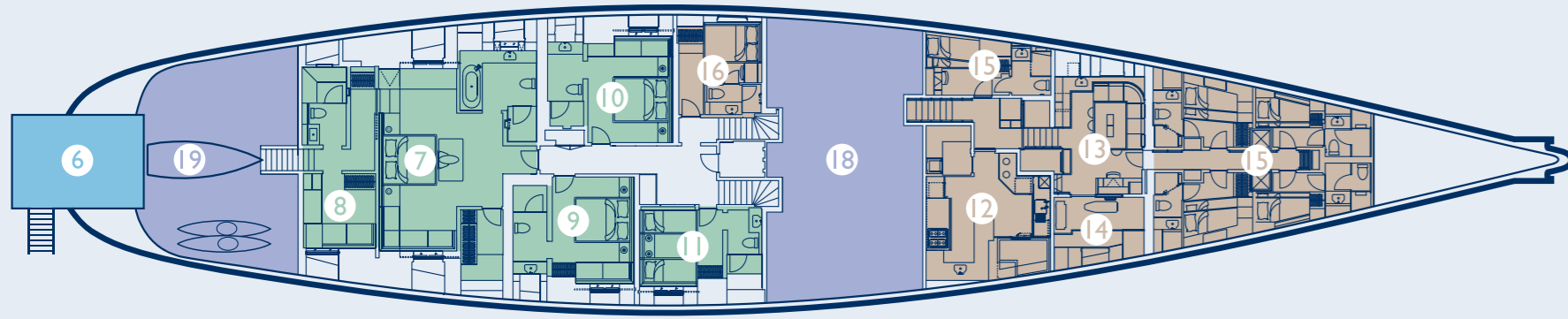
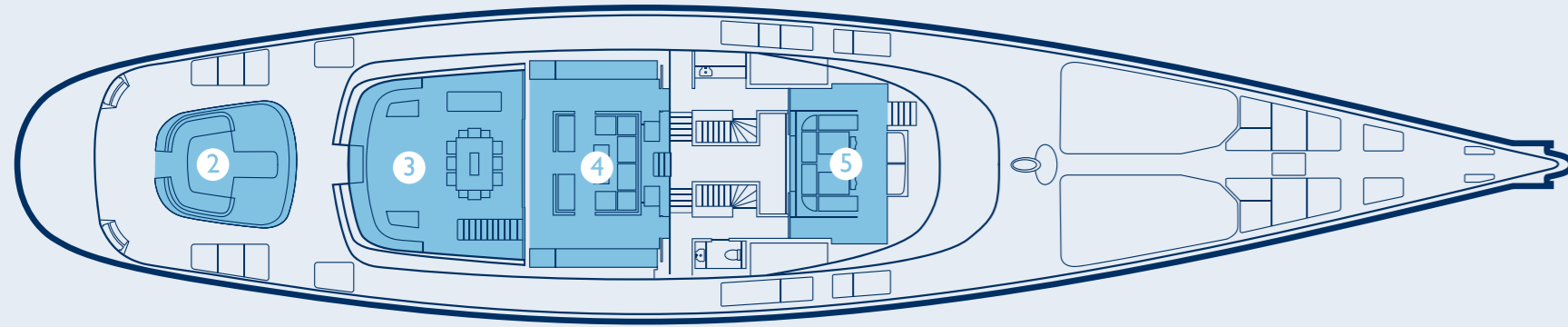
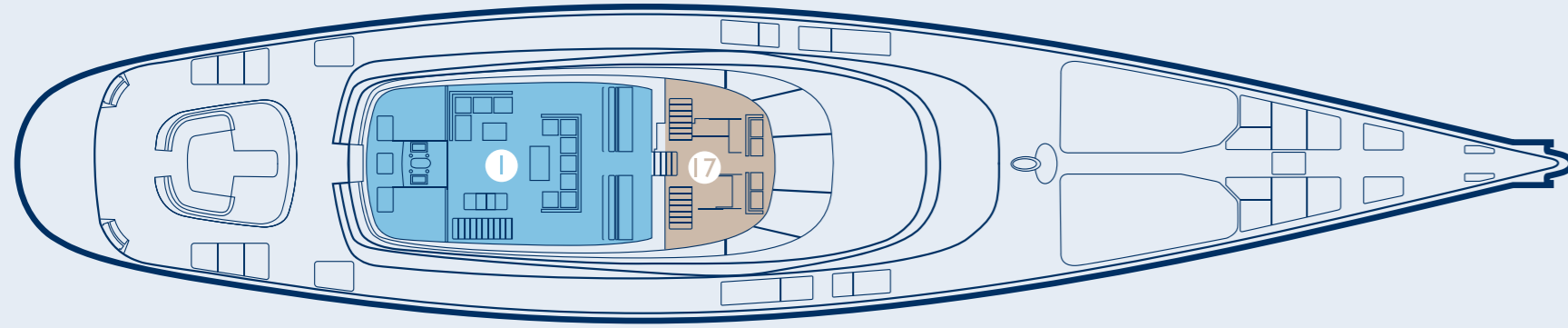

#### General Areas

- 1 Fly Bridge
- 2 Aft Seating Cockpit
- 3 Main Deck Cockpit
- 4 Main Saloon
- 5 Dining/TV Saloon
- 6 Swim/Beach Platform

#### Owner & Guest Cabins

- 7 Owners' Suite
- 8 Owners' Study
- 9 Guest Double Cabin 1
- 10 Guest Double Cabin 2
- 11 Guest Twin Cabin

#### Crew Areas

- 12 Galley
- 13 Crew Mess
- 14 Laundry
- 15 Crew Cabins
- 16 Captain's Cabin
- 17 Bridge/Ship Office

#### Technical Areas

- 18 Engine Room
- 19 Lazerette

## FLY BRIDGE

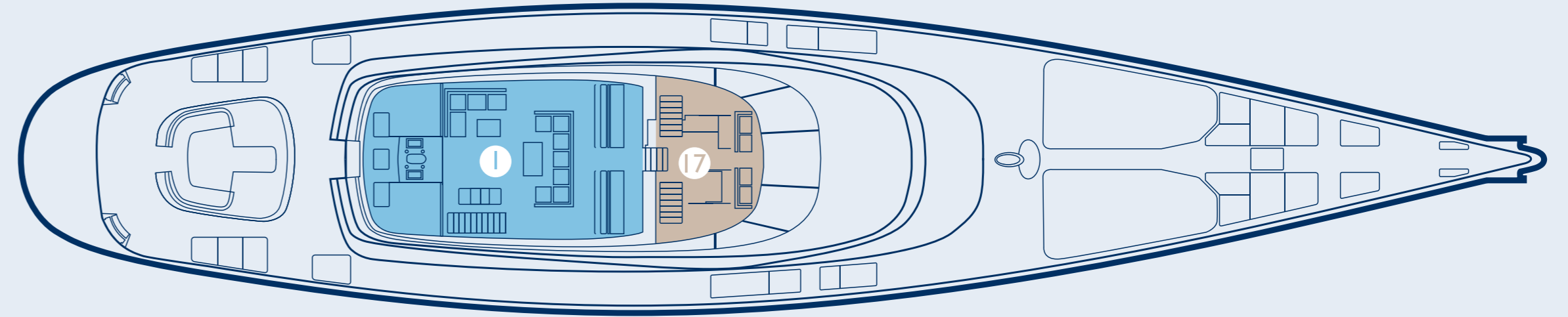

1. Fly Bridge



17. Bridge/Ship Office



# MAIN DECK

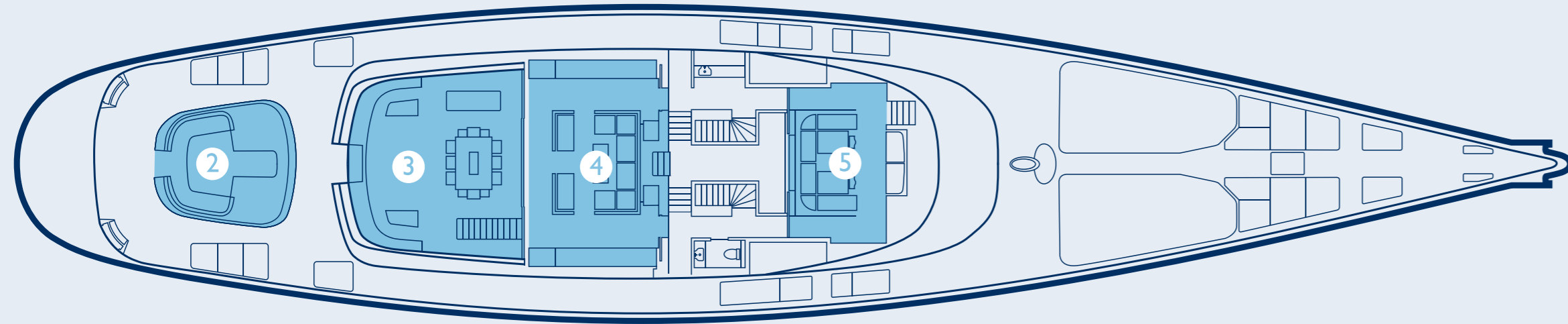

# LOWER DECK

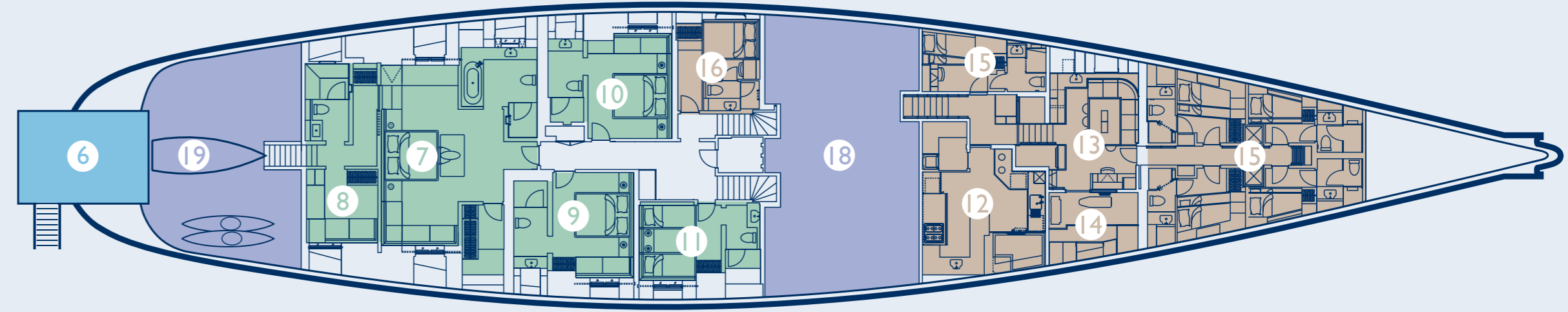

## GENERAL

**YARD NO.** 386

**TYPE** Flybridge Cutter Rigged Ketch

**NAVAL ARCHITECT** Dubois Naval Architects Ltd

## EXTERIOR AND INTERIOR DESIGN

Redman Whiteley Dixon Ltd

**INTERIOR DÉCOR** Todhunter Earle Interiors

## PROJECT MANAGEMENT

Steve Jacover –Yacht Project Management

Captain Gordon Percy – Owners’ Build Captain

## PAINT CONSULTANTS AND INSPECTION

CCS Coating Services

**BUILDER** Royal Huisman

**YEAR OF DELIVERY** 2010

## TECHNICAL INFORMATION

### HULL

- Length overall (l.o.a.) 57.49 m /188.61 ft
- Length on design waterline (d.w.l.) 48.95 m /160.73 ft
- Beam max. 11.59 m / 37.99 ft
- DWL draft to USK (max) board down 10.80 m /35.43 ft
- DWL draft to USK (min) board up 3.80 m /12.47 ft
- Displacement at DWL 550 tons / 1,212,543 lbs
- Gross tonnage 498 GT
- Hull speed 17 knots
- Range 4000 Nm at 12 knots boat speed

### RIG DIMENSIONS

- Main rig dimensions
l = 58.67 m / 192.49 ft
P= 53.60 m / 175.85 ft
E=17.25 m / 56.06 ft
J=19.25 m / 63.161 ft
- Mizzen rig dimensions
Py= 46.51 m / 152.59 ft
Ey= 14.05 m / 46.10 ft

### SAIL AREAS

- Main sail 544 m² / 5,857 ft²
- Staysail 189 m² / 2,029 ft²
- Genoa 821 m² / 8,839 ft²
- Blade jib 491 m² / 5,289 ft²
- Mizzen 399 m² / 4,268 ft²
- Gennekar1,742 m² / 18,747 ft²
- Mizzen Staysail 538 m² / 5,793 ft²
- Total area up-wind 1,952 m² / 21,007 ft²
- Total area down-wind 2,872 m² / 30,908 ft²

### CLASSIFICATION

Built according to MCA LY-2 and Lloyd’s X 100A1, SSC, YACHT, MONO, G6, [X] LMC, UMS

### CONSTRUCTION

- “Alustar” Temper H321(AA 5059-H321) aluminium for sheets and “Alustar”Temper H112 (AA5059-H112) for extrusions
- Centreboard in duplex stainless steel SAF 2205

### STEERING SYSTEM

- RHS custom designed and built hydraulically operated steering system with full sea state feed back
- Parker/Autopilot system and DP
- Marine Technologies (MT)
- 2 x exterior steering stations on the fly-bridge
- 1 x interior bridge steering station

### PROPULSION SYSTEM

- Caterpillar C32 Acert, B-rating, 970 kW @2100 rpm Main engine

### REDUCTION BOX

- ZF 3350, reduction 4 : 1

### PROPELLER INSTALLATION

- Wärtsilä Propulsion Controllable pitch propeller, diameter 1500 mm, four blades with high skew

### GENERATORS

- 3 x Northern Lights, M1066H, 155 kW – 50 Hz
- 3 x RHS/Greentop custom built regenerative soot filters with PLC control

### TANK CAPACITIES

- Fuel tanks 45,392
- Fresh water tanks 11,355
- Grey / Black water tanks 5,200

### THRUSTERS

- Hundested FT4RL, 130 kW Bow thruster
- Hundested FT4RS, 110 kW Stern thruster

### WATERMAKER

- Custom-built configuration based on:
2 x HEM 40 / Duplex / 4200 in custom frame, capacity 2 x 18,000 litres / day

### PNEUMATIC SYSTEM

- Atlas Copco 2 x SF-4-FF Air compressors

### DIVING SYSTEM

- Bauer diving compressor
- Hytech Nitrox production system
- Hydraulic system

### CUSTOM BOSCH REXROTH

- RHS manifold system for sail handling functions
- 3 x Main Engine power take offs
- 3 x Generator power take offs
- 2 x 400vac hydraulic pumps, frequency controlled

### GREY / BLACK WATER SYSTEM

- Hamann Mini Compact system with 1,000 litre holding tank - capacity 8,100 l/day
- Jets Evac vacuum system

### LUBE OIL / SLUDGE SYSTEM

- RHS custom-built lube oil / sludge system

### FRIDGE / FREEZER SYSTEM

- RHS custom-built remote compressors for fridges and freezers
- Fridge / Freezer boxes: custom built Rovasta

### HVAC

- Marine Air system based on fan-coils and fresh air units and dedicated chillers for electronics and racks

### ELECTRICAL SYSTEM

- 230/400 VAC-50Hz Electrical System
- Magnus Marine, 150kw Shore Power system
- Alewijnse, Power Management system
- Clean Net unit for elimination light fluctuation.
- Central UPS system with 24 x Emergency Lithium Ion batteries
- 8 x Starting battery with chargers (2 sets of 4 batteries)
- 2 x Radio batteries with charger
- 2 x Emergency Crane batteries with charger

### NAVIGATION EQUIPMENT

- Marine Technologies (MT)
- Integrated Bridge System (IBS)
- MT Dynamic Positioning System (DP)
- B&G Hydra 3000 Navigation system
- Radio Holland, Saab R4 DGPS/AIS
- Cassens & Plath, Navigat 2100 Gyro Compass
- Furuno NX-700B Navtex receiver
- Thrane & Thrane, Sailor TT-3000EB Satcom C

### STEERING STATIONS

- RHS / Radio Zeeland full glass touch screen panels with integrated widescreen displays at bridge and at flybridge helm stations

### COMMUNICATION EQUIPMENT

- Thrane & Thrane, Sailor system 5000 SSB
- Sailor, RT 4800 en TT 4802 VHF
- Cisco, 2851 Telephone exchange
- Seatel, Wavecall 4006 VSAT
- Altobridge GSM/3G mobile gateway via VSat
- Radio Holland GSM antenna
- Thrane & Thrane, FB-500 Fleet broadband

### CONTROL NETWORK

- Beckhoff CX PLC network based on TCP/IP 100 MB/s

### PC NETWORK

- Custom computer network based on fibre optic Cisco switches, ship–wide wireless access points, internet by satellite communication, Wi-Fi, Fleet and 3G, IDEA Vessel Information Organizer (VIO)

### ALARM SYSTEM

- RHS Alarm & Monitoring Ssystem (Twiznet)
- Alarm notification and forwarding system
- Eltek Fire alarm system
- General / Abandon ship and MOB alarm system
- Steward call system

### ENTERTAINMENT

- Harris Grant Integrated Entertainment system
- Kaleidascape DVD/CD Server for Movies and Central Music, Blue-Ray, Crestron media matrix/Soundweb audio matrix
- Streaming guest photo TV Channel and Information Channel
- Oculus Yacht Eye 3D Chart positioning TV Channel
- Crestron, iPad & iTouch remote control units
- Separately controllable Music Zones throughout the yacht, or a single Party Mode when required
- SAT-TV/SKY/DIRECT TV broadcasting cable television
- Nuvo Internet Radio and Streaming Music System
- Local FM Radio and Sat-TV News Channels in each zone

### INTERIOR STYLING

- Interior joinery style as per design of Redman Whiteley Dixon & Todhunter Earle Interiors
- Selected woods and veneers in aged European oak in combination with natural colour fabrics

### GLASS

- Optically tinted double curved chemically hardened glass windows by Yachtglass, the largest glass panels curved in 3 dimensions ever produced
- The Lloyds tested and approved triple layer glass construction requires no storm blinds

### INSULATION

- Rockwool / glass wool; Class approved insulation

### DECK HARDWARE

- Rondal custom-built deck stainless steel hardware cleats, bollards, fairleads, deck drains, etc To designs by Redman Whitely Dixon

### HATCHES

- Rondal custom-built hatches

### EXTERIOR DOORS

- Custom Rondal double leaf maximum glass sliding aft doors (3.5m opening), electrically driven through spindle drive
- Side entrance pantograph hinged doors, PCM, electrically operated

### WINCHES

- Rondal captive and drum winches
- Deck Winches 8 x CWL 8000 kg
- Captive Winches 19 x RV-2500 kg to RW-18000 kg

### ANCHOR SYSTEM

- 2 x Steen 23-09 hydraulically anchor winches
- 2 x 1,100 lbs stainless steel CQR bow anchors
- 2 x Anchor chain length 165 meter

### SIDE GANGWAY

- Ackerboom custom side gangway, manually operated, on SB

### SIDE PLATFORM

- 2 x RHS custom side platforms, hydraulically operated, on SB/PS

### PASSARELLE

- Yachttec custom Passarelle, hydraulically operated

### BOAT CRANE

- Concealed Custom C-Quip hydraulic knuckle-boom boat crane for launching the tenders on the fore deck

### STERN PLATFORM

- Custom RHS boarding/swim platform at variable heights with a custom hydraulically controlled carbon fibre C-quip swimming ladder
- Grand stairs provides access to the main deck

### TENDERS

- 2 x Castoldi diesel powered Jet Tender Model 21 stored in concealed forward deck tender wells 34kts

### SAFETY EQUIPMENT

- 6 x Zodiac Xtrem 8 persons life rafts
- Embarkation / pilot ladder
- Life saving equipment for all persons on board

### FIRE EQUIPMENT

- Seawater fire fighting systems
- Hi-Fog water mist fire fighting systems
- Novac I230 for engine room, control room and technical space bridge
- Argonite for main switchboard
- Portable fire extinguishers for engine room and accommodation

### SPORTS EQUIPMENT

- 2 x Laser Pico sailing dinghies
- 2 x Bic Oassou kayaks
- Full Scuba Diving (air and Nitrox)
- Snorkelling, swimming and water sports gear
- Water Skis, Wake board and other toys
- Beach BBQ equipment and tent

### PAINT SYSTEM

- Awlgrip Filler and top coat

### SPARS

- Southern Spars New Zealand carbon fibre masts and rollaway carbon booms

### STANDING RIGGING

- Southern Spars Rigging continuous EC6+ low profile rigging with titanium spreader tips
- Gleistein Spectra sheets

### RIGGING HYDRAULICS

- Rondal furlers

### SAILS

- North Sails 3DL Carbon/Aramid Sails
- North Sails Nylon Gennekar with C-Tech Snuffair inflatable snuffer - both A3 and A4
- North Sails Cuban Fibre Mizzen Staysail

### GUEST ACCOMMODATION

- 8/9 guests in 4 cabins (3 doubles, 1 twin, 1 pullman)
- Owner Suite: Full beam master suite with bathroom, spa shower and private study en suite
- Guest Suites: 2 x double cabins each with shower room en suite 1 x twin cabin with pullman berth and shower room en suite
- All guest accommodation has Kaleidascape DVD Server and iPod/iPhone Music & Movie, Blue-Ray, Crestron Media Matrix with Crestron and iTouch controls. Satellite TV broadcasting SAT/Cable/Sky TV; Radio and Internet Radio streaming; Chart and Ship’s Position and guest photo TV channel.

### INTERIOR AND EXTERIOR PHOTOGRAPHY

Ray Main

### AERIAL AND SAILING PHOTOGRAPHY

Bugsy Gedlek, Cory Silkin, Ingrid Abery,

Superyachtmedia.





[twizzle.org](http://twizzle.org)